

BLT-IN-5124 Electric Fireplace in Tuscan Cream, Moderno  
finish concrete face with optional Sable fire glass



# AMANTII PRODUCT LINE

---

## ELECTRIC FIREPLACES

*Amantii*

# TABLE OF CONTENTS

## WALL MOUNT / BUILT IN

### LED LIGHT - HEATER WITH FAN

WM-BI-28-3421 .....	4
WM-BI-43-5123 .....	5
WM-BI-58-6421 .....	6
WM-BI-76-8221 .....	7
WM-BI-106-11524 .....	8

### WM-BI BACK-LIT

WM-BI-29-3623 .....	9
WM-BI-35-4423 .....	10

### WM-BI BACK-LIT COLOURS .....

WM-BI-47-5823 .....	12
WM-BI-69-8123 .....	13

## ZERO CLEARANCE/INSERTS

### LED LIGHT - HEATER WITH FAN

#### ZERO CLEARANCE

ZECL-26-2923 .....	15
ZECL-30-3226 .....	16
ZECL-30 MANTLE .....	17
ZECL-33-3624 .....	18
ZECL-39-4134 .....	19
ZECL-2939 .....	20

#### INSERTS

INSERT-26-3825 .....	21
INSERT-30-4230 .....	22
INSERT-33-4230 .....	23

### ACCESSORIES & FIRE GLASS OPTIONS .....

## DESIGNER SERIES

### WALL MOUNT & BUILT-IN

### LED LIGHT & INCANDESCENT LIGHT HEATER WITH FAN & NO HEATER, NO FAN

WM-BI-43-5123 DESIGNER .....	26
------------------------------	----

### WM-BI-43 DESIGNER SERIES COLOUR OPTIONS .....

#### REAL STONE FACE UPGRADES

WM-38 .....	28
WM-58 .....	29

#### REAL STONE COLOR OPTIONS .....

WM-62 DESIGNER .....	31
----------------------	----

### WM-62 & BLT-IN-62 DESIGNER COLOUR OPTIONS .....

WM-102 .....	33
--------------	----

#### REAL STONE FACE UPGRADES

BLT-IN-38 .....	34
BLT-IN-58 .....	35
BLT-IN-62 DESIGNER .....	37

BLT-IN-5124 ARTISAN SERIES .....	39
----------------------------------	----

### CONCRETE FACE STYLES & COLOUR OPTIONS .....

## WALL MOUNT

### INCANDESCENT LIGHT - HEATER WITH FAN

WM-1641 .....	43
WM-2134 .....	43
WM-50 .....	44
WM-3522CF .....	44
WM-38 .....	45
WM-58 .....	46
WM-95 .....	47



Amantii produces a unique brand of electric fireplaces that combine the best elements of modern technology and traditional charm. **Visit us at [www.amantii.com](http://www.amantii.com).**



WM-BI-28-3421 Electric Fireplace  
shown with Sable fire glass

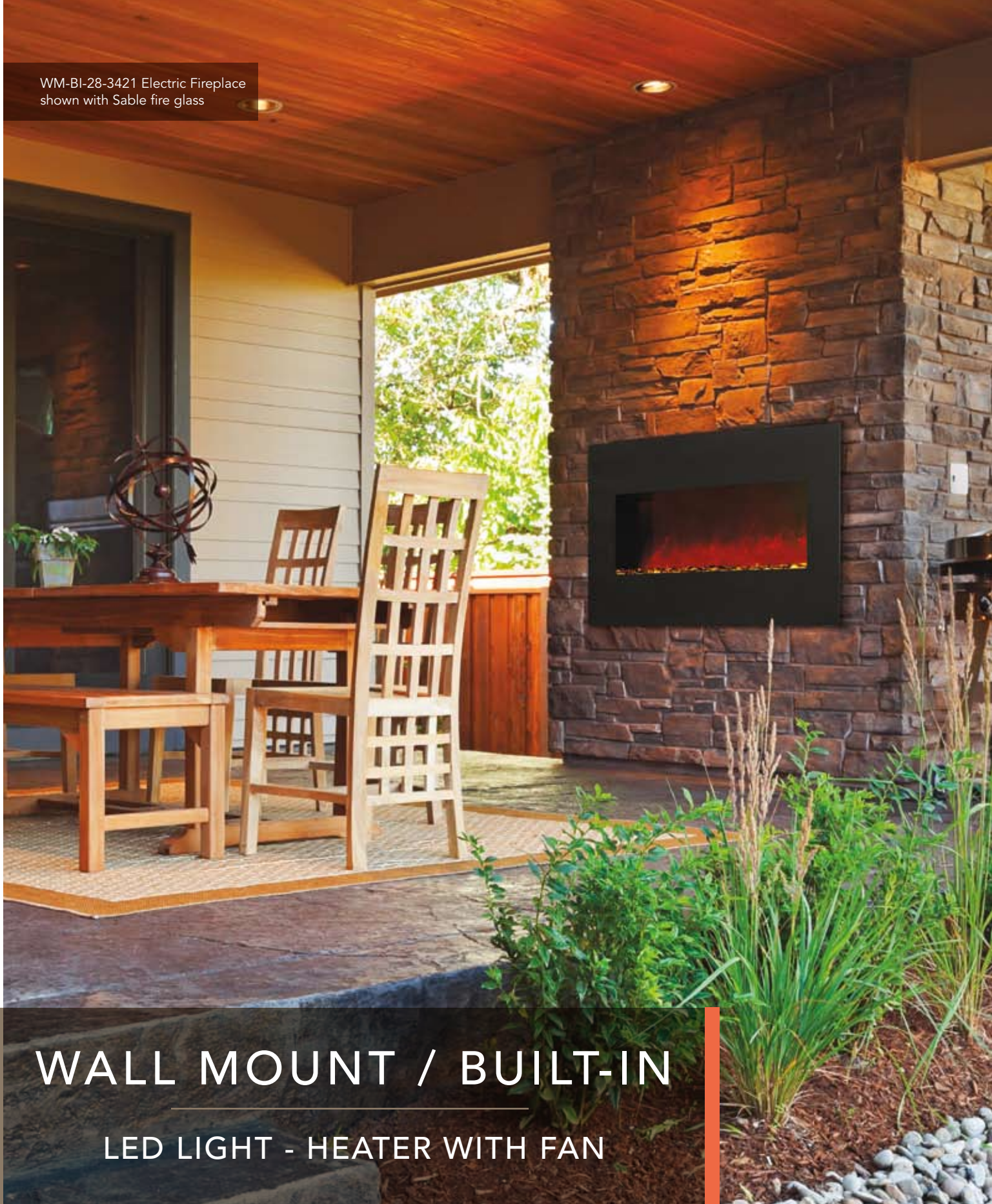

# WALL MOUNT / BUILT-IN

---

## LED LIGHT - HEATER WITH FAN



# WM-BI SERIES

WM-BI PROGRAMMABLE THERMOSTAT  
ADVANCED FLAME PRESENTATION  
LED LIGHTING WITH HEATER & FAN



WM-BI-28-3421 Electric Fireplace  
shown with log set

## WM-BI-28-3421 SPECIFICATIONS

### WM-BI SERIES

#### Fireplace Features

- Clean black glass face
- Optional Designer beveled steel face comes on the WM-BI-43-5123 only
- Can be wall mounted or built-in
- No grills
- Three stage heater
- 4-stage front and 4-stage back light
- Featuring an advanced flame presentation, the latest LED light technology with multi colour flame
- Heat can operate without flame
- Flame operates with or without heat
- Remote control for flame and heater included
- Digital display programmable thermostat
- Thermostat is located on remote and displayed on the fireplace in F or C
- Front and rear control for lighting effects
- Approx. heating area – 400 sq. ft.
- Plug located on the right side

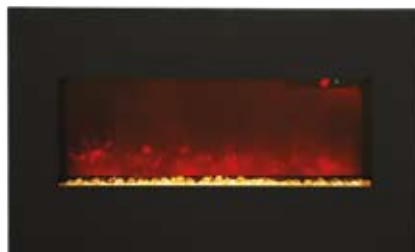

### WM-BI-28-3421

Built-in electric fireplaces are a perfect alternative for gas or wood burning fireplaces, solving impossible installation challenges and offering immediate gratification with same-day installation. If you have limited space, then the WM-BI-28-3421 is your answer and is designed to be wall mounted or built-in. Included with the WM-BI-28-3421 is a log set and three colours of fire glass media.

Volts	120
Amps	11.7
Watts	1400 max
Heater	1350 watts high, 675 watts low
No Heater	9 watts
Blower Motor	14.5 watts
Small Motor	4 watts
Height, Width, Depth	17 x 28 x 5 1/2
Glass Viewing Opening	24 5/8 x 9 3/16
Glass Size	34 x 21
Shipping Size	37 1/4 x 10 1/4 x 25
Shipping Weight	48 lbs. Glass Included
Cord Length	75"

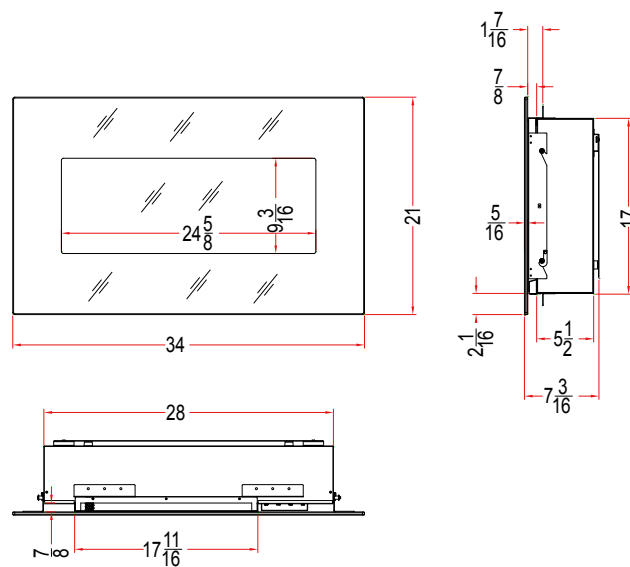



WM-BI-43-5123 Electric Fireplace shown with black glass front and optional Blaze fire glass

# WM-BI-43-5123 SPECIFICATIONS

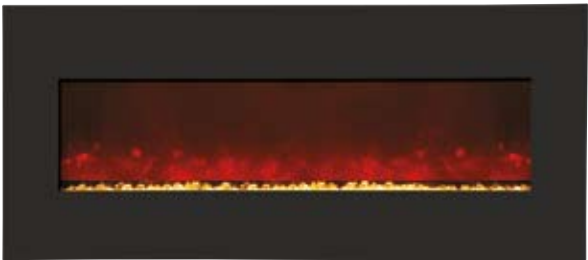

## WM-BI-43-5123

Opportunities abound with the WM-BI-43-5123 electric fireplace. Choose between sleek black glass or the new stylish Designer beveled steel faces. Add personal style to your room and change the fireplace media at any time. The WM-BI-43-5123 is designed to be wall mounted or built-in. Comes with log set and three colours of fire glass media on page 24.

Volts	120
Amps	11.7
Watts	1400 max
Heater	1350 watts high, 675 watts low
No Heater	11 watts
Blower Motor	14.5 watts
Small Motor	4 watts
Height, Width, Depth	17 x 43 x 5 1/2
Glass Viewing Opening	39 1/2 x 9 3/16
Glass Size	51 x 23
Shipping Size	55 x 10 3/8 x 27 1/2
Shipping Weight	72 lbs. Glass Included
Cord Length	75"

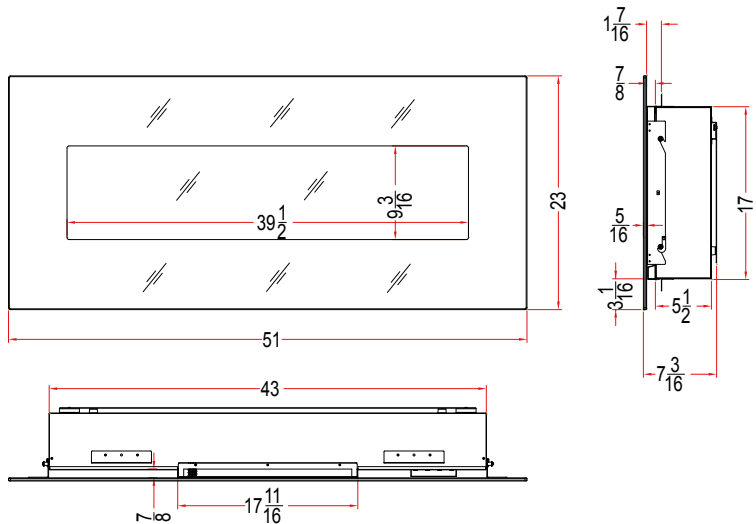





WM-BI-58-6421 Electric Fireplace with log set

## WM-BI 58-6421 SPECIFICATIONS



### WM-BI-58-6421

Revamp any room with the beautiful WM-BI-58-6421 electric fireplace. Designed to be wall mounted or built-in. Comes with log set and three colours of fire glass media.

Volts	120
Amps	11.7
Watts	1400 max
Heater	1350 watts high, 675 watts low
No Heater	18 watts
Blower Motor	14.5 watts
Small Motor	10 watts
Height, Width, Depth	17 x 58 x 5 1/2
Glass Viewing Opening	54 7/16 x 9 3/16
Glass Size	64 x 21
Shipping Size	68 x 10 3/8 x 25 5/8
Shipping Weight	87 lbs. Glass Included
Cord Length	75"

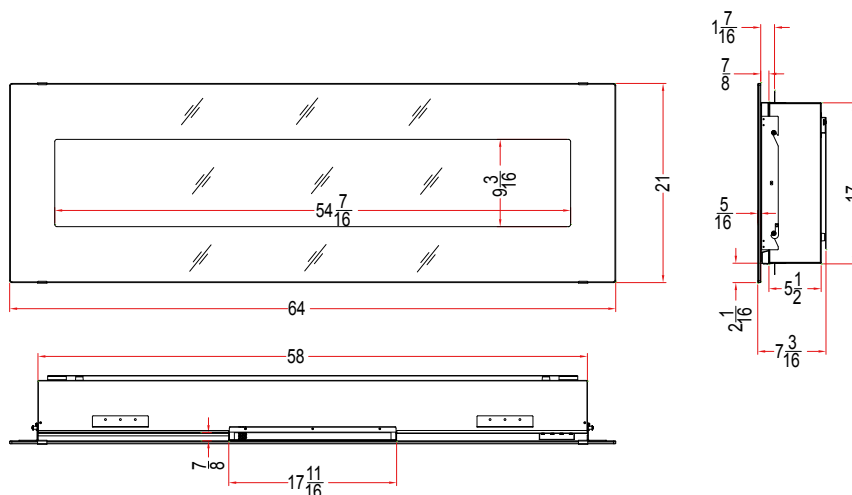

*ambiance*

WM-BI-76-8221 Electric Fireplace with optional Sunset fire glass

## WM-BI 76-8221 SPECIFICATIONS

### WM-BI-76-8221

Have a larger space to fill? The WM-BI-76-8221 is a perfect solution. Designed to be wall mounted or built-in. Comes with log set and three colours of fire glass media.

Volts	120
Amps	11.7
Watts	1400 max
Heater	1350 watts high, 675 watts low
No Heater	20 watts
Blower Motor	14.5 watts
Small Motor	10 watts
Height, Width, Depth	17 x 76 x 5 1/2
Glass Viewing Opening	72 7/16 x 9 3/16
Glass Size	82 x 21
Shipping Size	87 x 11 1/4 x 25 5/8
Shipping Weight	107 lbs. Glass Included
Cord Length	75"

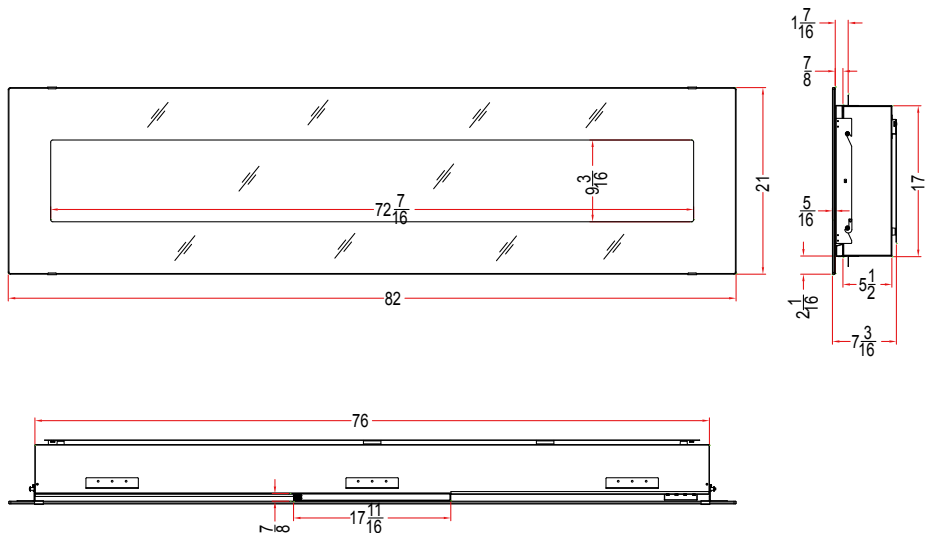



professional



WM-BI-106-11524 Electric Fireplace with Clear fire glass

## WM-BI-106-11524 SPECIFICATIONS



### WM-BI-106-11524

With an amazing length of 115" the WM-BI-106-11524 electric fireplace is bound to turn heads. An excellent choice for commercial installations, this stunning unit can be built in or wall mounted. The state of the art lifelike flame comes alive in one of the biggest glass viewing areas in the industry. Comes with log set and three colours of fire glass media.

Volts	120
Amps	11.7
Watts	1400 max
Heater	1350 watts high, 675 watts low
No Heater	25 watts
Blower Motor	14.5 watts
Small Motor	10 watts
Height, Width, Depth	17 x 106 x 5 1/2
Glass Viewing Opening	102 1/2 x 9 3/16
Glass Size	115 x 24
Shipping Size	120 x 11 1/4 x 28 1/2
Shipping Weight	158 lbs. Glass Included
Cord Length	75"

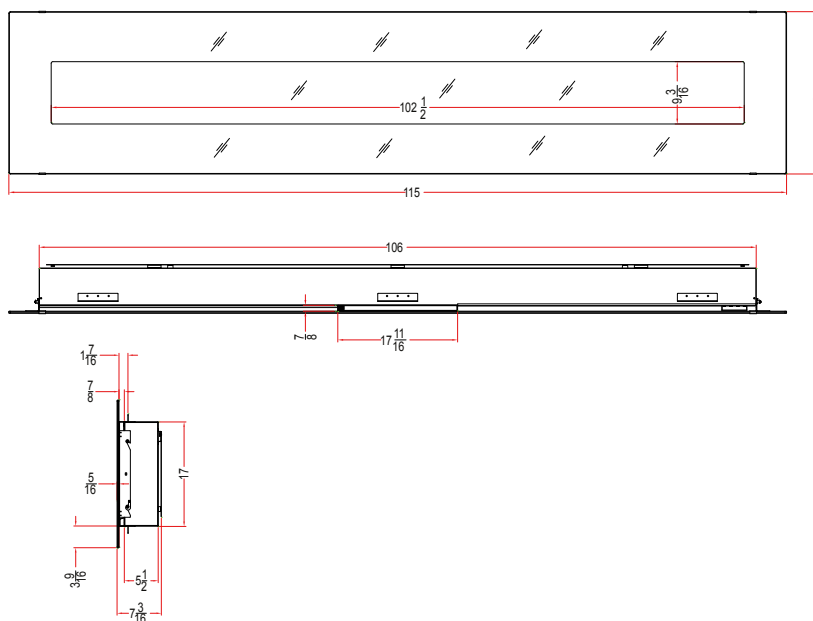



## WM-BI SERIES

WM-BI TEMPERATURE MAINTENANCE  
CONTROL AND BACK-LIGHTING  
LED LIGHTING WITH HEATER & FAN



WM-BI-26-3623 Electric Fireplace with  
Mystic Green back-lit light and log set

### WM-BI-26-3623 SPECIFICATIONS

#### WM-BI SERIES

##### Fireplace Features

- Clean black glass face
- No grills
- Three stage heater
- Can be wall mounted or built-in
- 4-stage front and 4-stage back light
- Featuring the latest LED light technology
- Comes with two remote controls. One is for the 13 colours of back-lit mood lighting, the other is for the flame and heater
- Maintains a constant temperature between 20-25° C
- Heat is vented out the bottom
- Heat can operate without flame
- Flame operates with or without heat
- Approx. heating area – 400-500 sq. ft.
- Front and rear control for lighting effects
- Plug located on the left side
- Three colours of fire glass media & log all included in the box



#### WM-BI-26-3623

The clean and modern WM-BI-26-3623 will add an impressive glow to any space. Not only does this model feature temperature maintenance controls but it features back lights with 13 colours to choose from. Simple to wall mount or build-in to the wall for a custom finished look. Comes standard with three colours of fire glass media and log in the box.

Volts	120
Amps	12.5
Watts	1500 max
Heater	1500 watts high, 750 watts low
No Heater	22 watts
Lamps	LED 22 watts
Rotor Motor	1 at 5 watts
Height, Width, Depth	21 1/4 x 26 x 6
Glass Viewing Opening	23 1/2 x 10
Glass Size	35 1/2 x 23
Shipping Size	38 3/4 x 9 1/8 x 25 5/8
Shipping Weight	55.7 lbs. Glass Included
Cord Length	76"

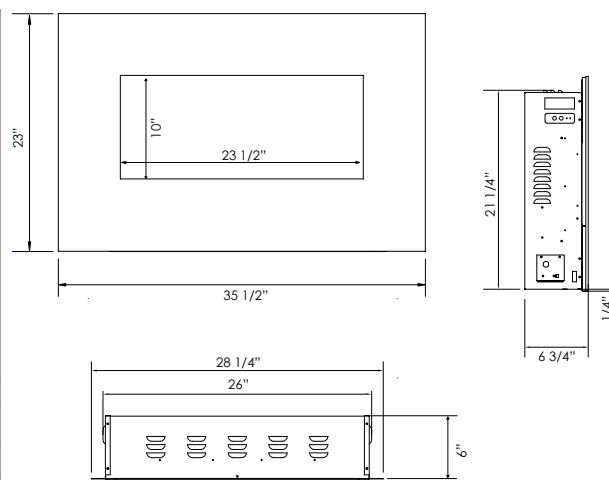



WM-BI-34-4423 Electric Fireplace with Cobblestone Blue back-lit light and Harvest Moon fire glass

*Burst of colour*

## WM-BI-34-4423 SPECIFICATIONS

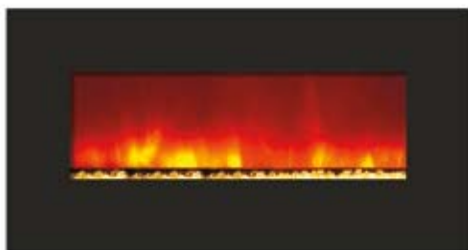

### WM-BI-34-4423

Warm up any space with the sleek and sophisticated WM-BI-34-4423, featuring temperature maintenance controls and the ability to add a back lit glow in your choice of 13 colours. This stylish unit will add a touch of elegance to a space by day and a splash of colour by night. Unit can be wall mounted or built-in to the wall for a more custom look and finish. Comes standard with three colours of fire glass media and log in the box.

Volts	120
Amps	12.5
Watts	1500 max
Heater	1500 watts high, 750 watts low
No Heater	22 watts
Lamps	LED 22 watts
Rotor Motor	1 at 5 watts
Height, Width, Depth	21 1/4 x 34 x 6
Glass Viewing Opening	31 1/2 x 10
Glass Size	43 1/2 x 23
Shipping Size	46 3/4 x 9 1/8 x 25 5/8
Shipping Weight	65.8 lbs. Glass Included
Cord Length	76"

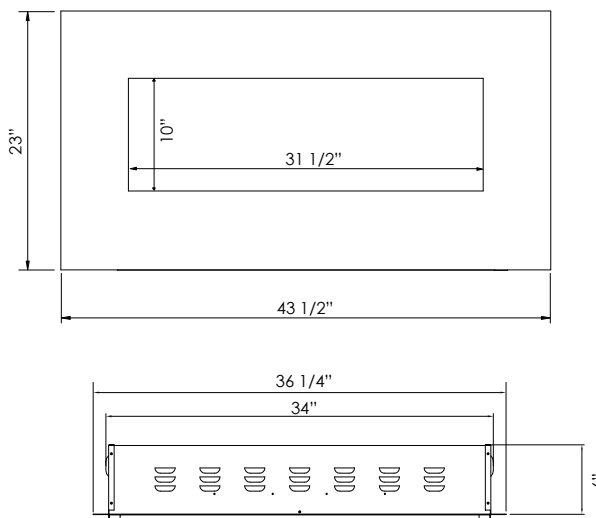





WM-BI-48-5823 Electric Fireplace with Sapphire Blue back-lit light

## WM-BI SERIES BACK-LIT COLOURS

(Available for WM-BI Series 26", 34", 48" and 72" models only. Comes with 13 colours to choose from.)



Shown with Smoky Amber Back-Lit

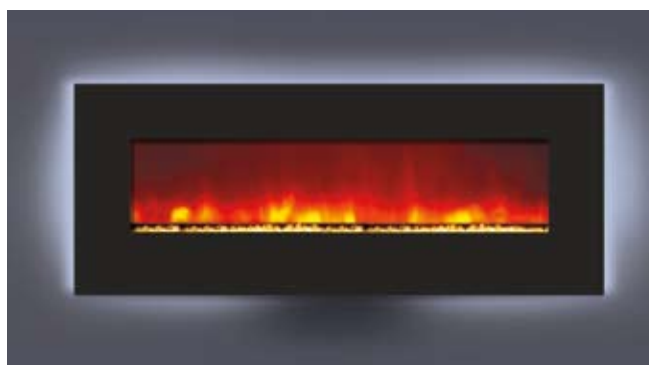

Shown with Cobblestone Blue Back-Lit

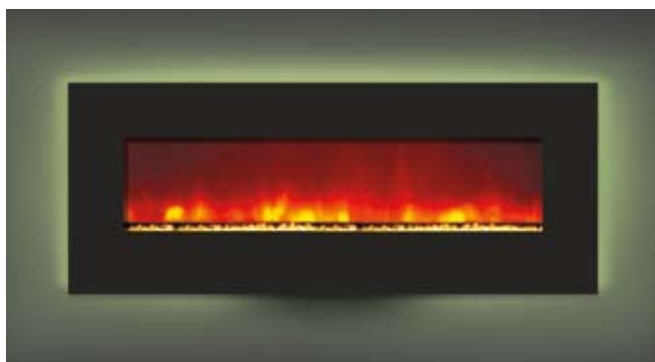

Shown with Mystic Green Back-Lit

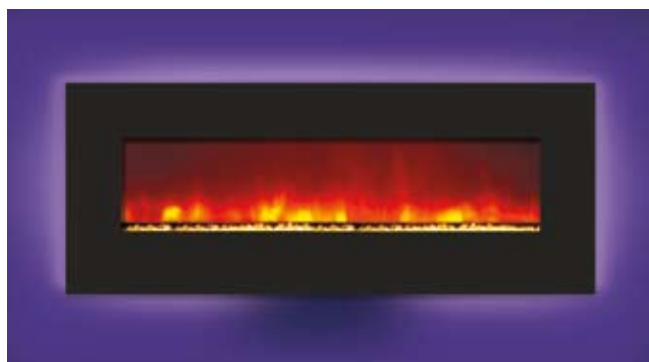

Shown with Imperial Purple Back-Lit



WM-BI-48-5823 Electric Fireplace with Imperial Purple back-lit light and log set

# WM-BI-48-5823 SPECIFICATIONS

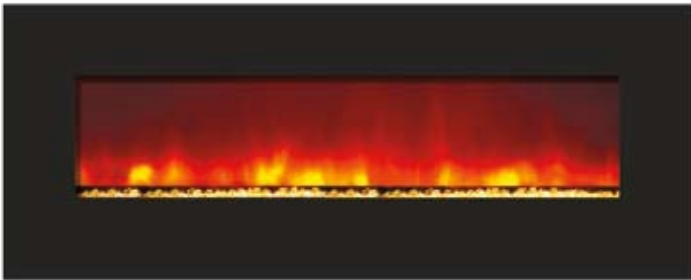

## WM-BI-48-5823

Impressive and functional. The WM-BI-48-5823 will heat up a room in more ways than one – featuring 13 colours of ambient back lighting, this unit adds wow factor to any space. The WM-BI-48-5823 features temperature maintenance controls and the ability to be wall mounted or built-in to a wall for a custom finished look. Comes standard with three colours of fire glass media and log in the box.

Volts	120
Amps	12.5
Watts	1500 max
Heater	1500 watts high, 750 watts low
No Heater	22 watts
Lamps	LED 22 watts
Rotor Motor	1 at 5 watts
Height, Width, Depth	21 1/4 x 48 x 6
Glass Viewing Opening	45 1/2 x 10
Glass Size	57 1/2 x 23
Shipping Size	60 3/4 x 9 1/8 x 25 5/8
Shipping Weight	82.2 lbs. Glass Included
Cord Length	76"

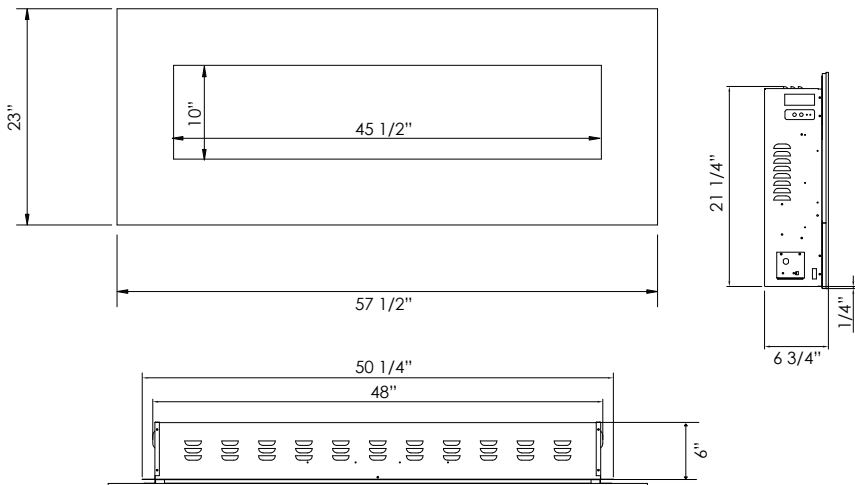





WM-BI-72-8123 Electric Fireplace with Smoky Amber back-lit light and optional Goldenrod fire glass

## WM-BI-72-8123 SPECIFICATIONS

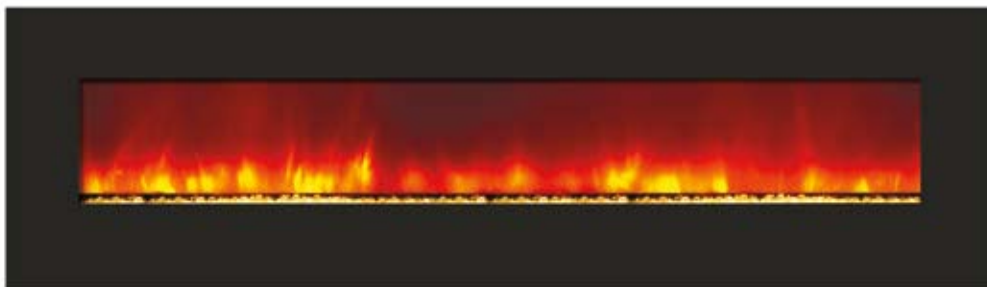

### WM-BI-72-8123

The WM-BI-72-8123 adds ambiance to any space with its optional back lit glow in your choice of 13 different colours. Unit is easy to wall mount or for a more custom look build right into the wall. Comes standard with three colours of fire glass media and log in the box.

Volts	120
Amps	12.5
Watts	1500 max
Heater	1500 watts high, 750 watts low
No Heater	22 watts
Lamps	LED 22 watts
Rotor Motor	1 at 5 watts
Height, Width, Depth	21 1/4 x 71 1/2 x 6
Glass Viewing Opening	69 x 10
Glass Size	81 x 23
Shipping Size	84 1/4 x 9 1/8 x 25 5/8
Shipping Weight	115.3 lbs. Glass Included
Cord Length	76"

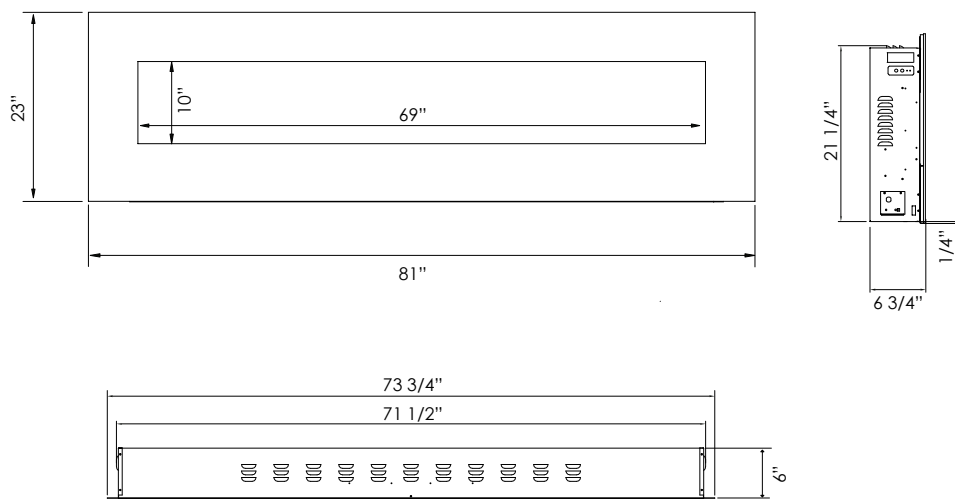



ZECL-30-3226 Electric Fireplace with log set  
and optional ZECL-30 mantle in Espresso

## ZERO CLEARANCE & INSERTS

LED LIGHT - HEATER WITH FAN



# ZERO-CLEARANCE SERIES



ZECL-26-2923 Electric Fireplace with Harvest Moon fire glass

## ZECL-26-2923 SPECIFICATIONS

### ZERO CLEARANCE SERIES Fireplace Features

- Clean black glass face
- No grills
- Three stage heater
- 4-stage front and 4-stage back light
- Featuring the latest LED light technology with multi colour
- Heat can operate without flame
- Approx. heating area – 400-500 sq. ft.
- Flame operates with or without heat
- Remote control for flame and heater included
- Front and rear control for lighting effects
- Plug located on the left side
- Three colours of fire glass media & log all included in the box



### Enduring Style.

By design the ZECL-26-2923 is an excellent choice for new construction or renovation projects. Simple and quick to install, this aesthetically pleasing unit features a black glass surround that easily compliments any decor. Comes with three colours of fire glass media & log set.

Volts	120
Amps	12.5
Watts	1500 max
Heater	1500 watts high, 750 watts low
No Heater	22 watts
Lamps	LED 22 watts
Rotor Motor	1 at 5 watts
Height, Width, Depth	22 1/2 x 25 1/2 x 8 1/2
Glass Viewing Opening	21 x 11 3/8
Glass Size	29 1/4 x 23
Shipping Size	25 1/4 x 32 3/4 x 12 1/4
Shipping Weight	55 lbs. Glass Included
Cord Length	76"

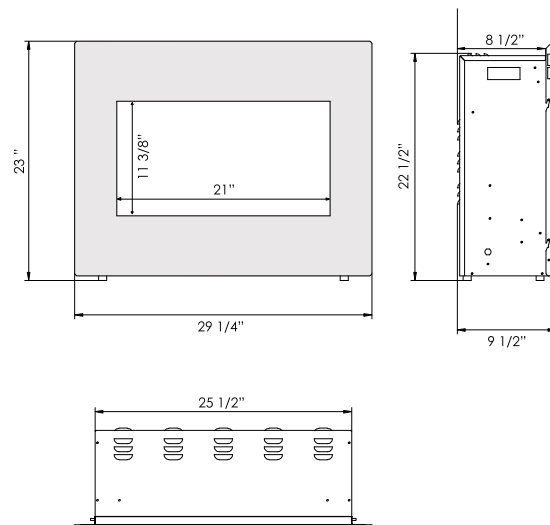

work of art



ZECL-30-3226 Electric Fireplace with log set in a ZECL-30 Simply White Mantle

## ZECL-30-3226 SPECIFICATIONS



### Hot & Fashionable.

Designed for new construction or renovation projects, the electric ZECL-30-3226 is an excellent alternative to gas or wood fireplaces. Quick and easy installation allows for immediate enjoyment of the state-of-the-art flame and heating system. Comes with three colours of fire glass media & log set.

*The ZECL-30-3226 also fits into our optional ZECL-30 Mantel (see page 17).*

Volts	120
Amps	12.5
Watts	1500 max
Heater	1500 watts high, 750 watts low
No Heater	22 watts
Lamps	LED 22 watts
Rotor Motor	1 at 5 watts
Height, Width, Depth	24 3/4 x 29 1/2 x 8 1/2
Glass Viewing Opening	24 5/8 x 13
Glass Size	32 1/2 x 25 5/8
Shipping Size	27 3/4 x 35 1/4 x 12 1/4
Shipping Weight	64 lbs. Glass Included
Cord Length	76"

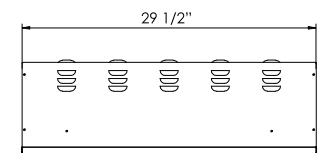
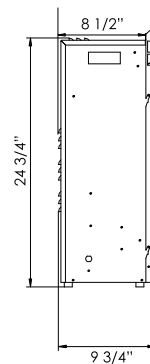
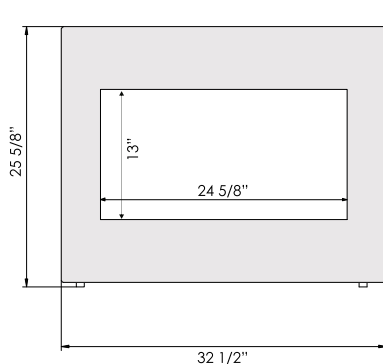

# ZECL-30 MANTLE



## Quality Craftsmanship.

The ZECL-30 mantle is beautifully hand crafted from maple hardwood and is the perfect mantle to house the ZECL-30-3226. The mantle is available unfinished and ready to take on any colour you choose, as well as in two stained finishes - Simply White and Espresso. It is easy to assemble and available only for the ZECL-30-3226. *Cabinet (left) shown in Espresso. Unassembled pieces below.*

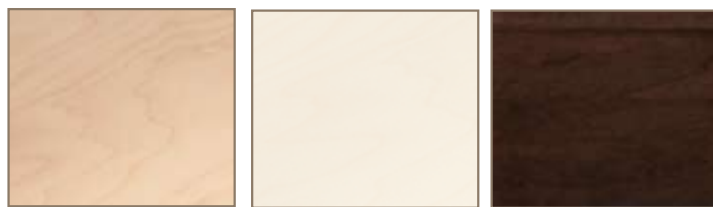

Natural Grain  
(unfinished)

Simply White

Espresso

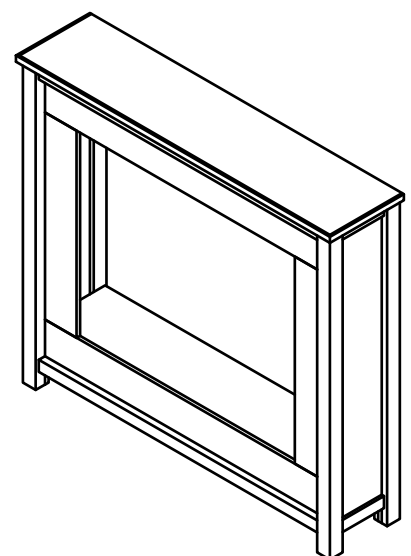
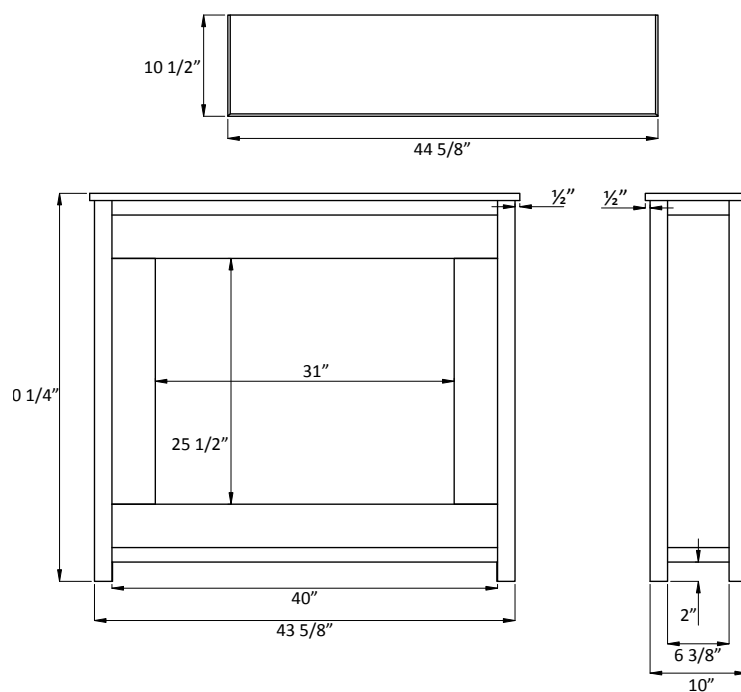



*versatile*



ZECL-33-3624 Electric Fireplace  
with optional Blaze fire glass

## ZECL-33-3624 SPECIFICATIONS



### Clean & Distinct.

An excellent alternative to gas or wood fireplaces, the electric ZECL-33-3624 is designed for new construction or renovation projects. Enjoy the state-of-the-art flame and heating system faster thanks to a quick and easy installation. Comes with three colours of fire glass media & fire log.

Volts	120
Amps	12.5
Watts	1500 max
Heater	1500 watts high, 750 watts low
No Heater	22 watts
Lamps	LED 22 watts
Rotor Motor	1 at 5 watts
Height, Width, Depth	22 1/4 x 30 3/4 x 8 1/2
Glass Viewing Opening	30 x 11 1/2
Glass Size	36 x 24
Shipping Size	26 x 38 1/4 x 12 1/4
Shipping Weight	66 lbs. Glass Included
Cord Length	76"

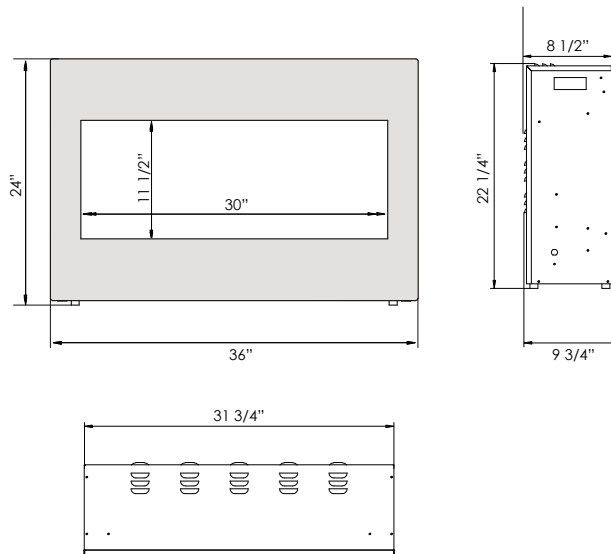



ZECL-39-4134 Electric Fireplace  
with optional Sable fire glass

## ZECL-39-4134 SPECIFICATIONS



### Striking & Bold.

This bold unit is both eye catching and practical. The ZECL-39-4134 is designed for easy, fast installation and is perfect for new construction builds or renovations. Features a black glass surround and comes with three colours of fire glass media & fire log.

Volts	120
Amps	12.5
Watts	1500 max
Heater	1500 watts high, 750 watts low
No Heater	22 watts
Lamps	LED 22 watts
Rotor Motor	1 at 5 watts
Height, Width, Depth	32 x 37 1/2 x 8 1/2
Glass Viewing Opening	30 7/8 x 20 3/8
Glass Size	41 x 34 1/2
Shipping Size	36 3/8 x 44 1/8 x 12 1/4
Shipping Weight	86 lbs. Glass Included
Cord Length	76"

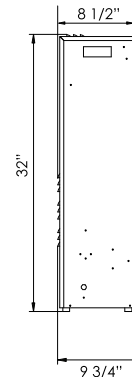
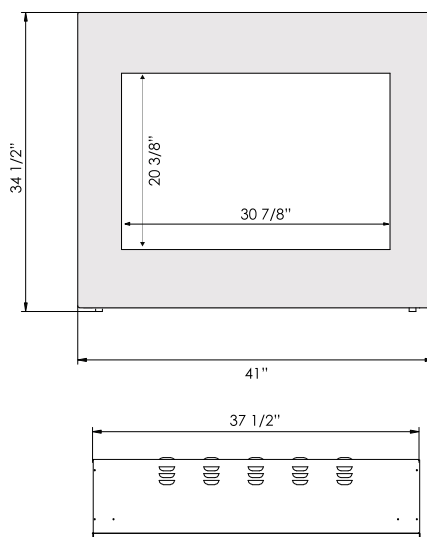





ZECL-2939 Electric  
Fireplace with log set

## ZECL-2939 SPECIFICATIONS



### Versatile & Cozy.

The ZECL-2939 electric fireplace is a stylish, vertical option. It gives you the benefit of fitting easily into a small room and adding warmth to any space in your home. Comes with three colours of fire glass media & log. Ideal for new construction or renovations.

Volts	120
Amps	12.5
Watts	1500 max
Heater	1500 watts high, 750 watts low
No Heater	22 watts
Lamps	LED 22 watts
Rotor Motor	1 at 5 watts
Height, Width, Depth	37 3/4 x 24 1/4 x 8 1/2
Glass Viewing Opening	21 1/2 x 26 3/4
Glass Size	29 1/2 x 39 1/4
Shipping Size	41 x 32 1/2 x 12 1/4
Shipping Weight	66 lbs. Glass Included
Cord Length	76"

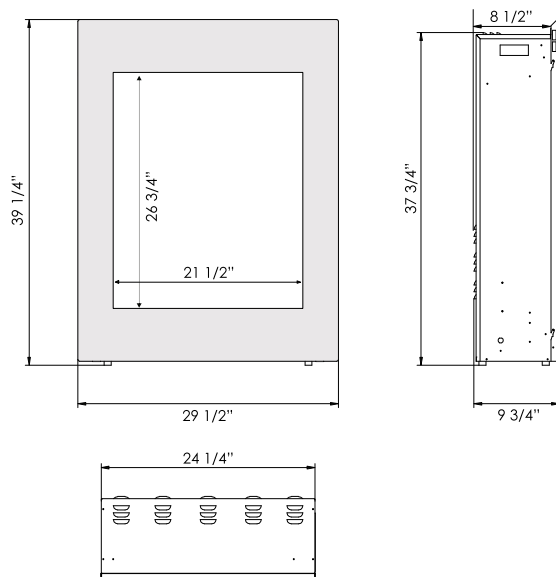

# INSERT SERIES



Small INSERT-26-3825 Electric Fireplace with optional Goldenrod fire glass

## INSERT-26-3825 SPECIFICATIONS

### INSERT SERIES Fireplace Features

- Clean black glass face
- No grills
- Three stage heater
- 4 stage front and 4 stage back light
- 4 leveling legs on the underside
- Featuring the latest LED light technology with multi colour
- Heat can operate without flame
- Approx. heating area – 400-500 sq. ft.
- Flame operates with or without heat
- Remote control for flame and heater included
- Front and rear control for lighting effects
- Plug located on the left side
- Cord length - 76"
- Three colours of fire glass media & log all included in the box



### Ideal for Home Improvements

Designed as an alternative for wood or gas inserts the INSERT-26-3825 is modern and sophisticated. This unit is quick and easy to install making it an ideal application if you are renovating an existing fireplace. Comes with three colours of fire glass media & log set.

Volts	120
Amps	12.5
Watts	1500 max
Heater	1500 watts high, 750 watts low
No Heater	22 watts
Lamps	LED 22 watts
Rotor Motor	1@5 watts
Height, Width, Depth	16 3/4 x 25 1/4 x 8 1/2
Glass Viewing Opening	23 3/4 x 9 1/2
Glass Size	38 x 25
Shipping Size	27 1/4 x 41 3/8 x 12 1/4
Shipping Weight	62 lbs. Glass Included

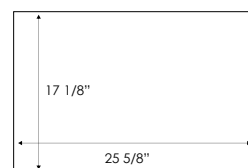
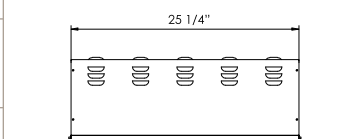
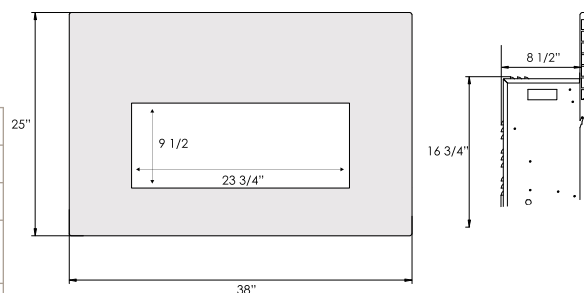

Minimum opening size required 17 1/8" H x 25 5/8" W

**INSERT-26-3825**  
winner of a Vesta Award  
in Electric Products.

The Vesta Awards recognize  
specific products for innovation  
in design and/or technology.







Medium INSERT-30-4230 Electric Fireplace with a mix of Clear and Harvest Moon fire glass

# INSERT-30-4026 SPECIFICATIONS

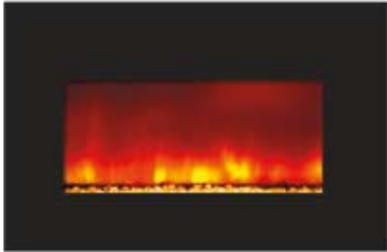

## Practical & Efficient.

Breathe new life into existing masonry or metal fireplaces with the stylish electric Insert-30-4026. Designed as an alternative to wood or gas units the Insert-30-4026 is modern and sophisticated. This medium sized unit is ideal for renovations and is quick and easy to install. Comes with three colours of fire glass media & log.

Volts	120
Amps	12.5
Watts	1500 max
Heater	1500 watts high, 750 watts low
No Heater	22 watts
Lamps	LED 22 watts
Rotor Motor	1@5 watts
Height, Width, Depth	19 1/4 x 29 1/2 x 8 1/2
Glass Viewing Opening	26 3/4 x 11 1/2
Glass Size	40 x 26
Shipping Size	32 3/8 x 44 3/4 x 12 1/4
Shipping Weight	73 lbs. Glass Included

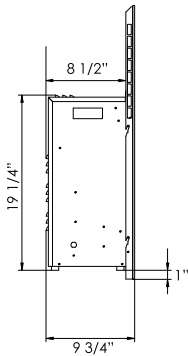
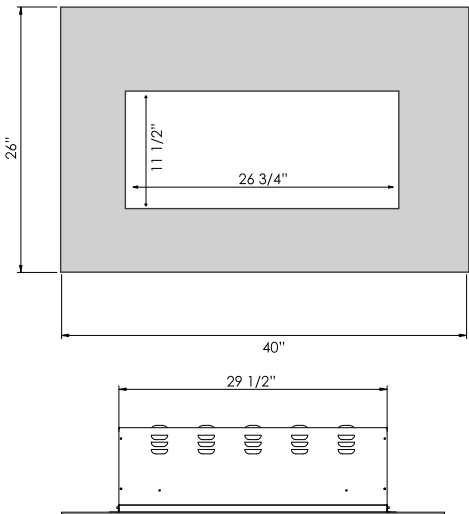

Minimum opening size required 19 5/8" H x 29 7/8" W



Large INSERT-33-4230 Electric Fireplace with log set

*make an impact*

## INSERT-33-4230 SPECIFICATIONS



### Charming & Resourceful.

A perfect alternative for wood or gas inserts, the electric Insert-33-4230 is stylish and practical. This large sized unit is quick and easy to install making it an ideal application if you are renovating an existing fireplace. Comes with three colours of fire glass media & log.

Volts	120
Amps	12.5
Watts	1500 max
Heater	1500 watts high, 750 watts low
No Heater	22 watts
Lamps	LED 22 watts
Rotor Motor	1@5 watts
Height, Width, Depth	22 1/4 x 31 3/4 x 8 1/2
Glass Viewing Opening	29 3/4 x 11 3/4
Glass Size	42 x 30
Shipping Size	32 3/8 x 45 1/8 x 12 1/4
Shipping Weight	80 lbs. Glass Included

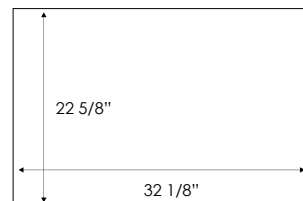
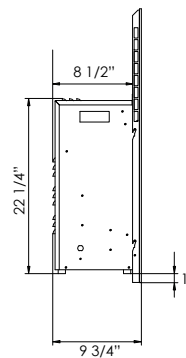
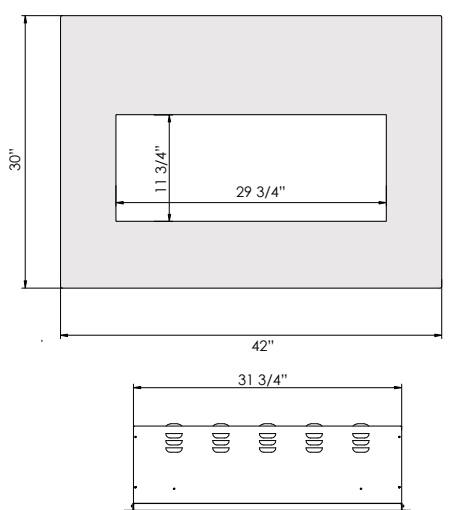

Minimum opening size required 22 5/8" H x 32 1/8" W



## ACCESSORIES & FIRE GLASS OPTIONS



WM-BI-58 Electric Fireplace with log set

### LOG SET

The logs come with both the WM-BI Series, ZECL Series, Insert Series and the WM-50.



*Variations in colour and shade are inherent in all printing processes, the actual colours may vary slightly from those shown in this brochure. Please visit your local dealer to view a sample.*

### FIRE GLASS COLOURS

The three fire glass colours below are included with the WM-BI Series, ZECL Series, BLT-IN Series, WM-50 and WM-3522CF



Hz-01 Clear



Hz-04 Harvest Moon



Hz-09 Sun Tea

### OPTIONAL FIRE GLASS

The three optional fire glass colours below are available to purchase at an additional charge.



Hz-05 Goldenrod



Hz-06 Blaze



Hz-07 Sunset



Hz-08 Sable

BLT-IN-5124 Electric Fireplace in Tuscan Cream, Moderno  
finish concrete face with optional Sable fire glass



## DESIGNER SERIES

WALL MOUNT & BUILT-IN  
LED LIGHT • INCANDESCENT LIGHT  
HEATER WITH FAN • NO HEATER, NO FAN



# WM-BI DESIGNER SERIES

WM-BI PROGRAMMABLE THERMOSTAT  
ADVANCED FLAME PRESENTATION  
LED LIGHTING WITH HEATER & FAN



WM-BI-43-5123 Designer Electric Fireplace shown in Candy Apple Red with optional Sunset fire glass

## WM-BI-43-5123 DESIGNER SPECIFICATIONS

### WM-BI DESIGNER SERIES Fireplace Features

- Optional Designer beveled steel face comes on the WM-BI-43-5123 only
- Can be wall mounted or built-in
- No grills
- Three stage heater
- 4-stage front and 4-stage back light
- Featuring an advanced flame presentation, the latest LED light technology with multi colour flame
- Heat can operate without flame
- Flame operates with or without heat
- Remote control for flame and heater included
- Digital display programmable thermostat
- Thermostat is located on remote and displayed on the fireplace in F or C
- Front and rear control for lighting effects
- Approx. heating area – 400 sq. ft.
- Plug located on the right side



Volts	120
Amps	11.7
Watts	1400 max
Heater	1350 watts high, 675 watts low
No Heater	11 watts
Blower Motor	14.5 watts
Small Motor	4 watts
Height, Width, Depth	17 x 43 x 5 1/2
Glass Viewing Opening	39 1/2 x 9 3/16
Glass Size	51 x 23
Shipping Size	55 x 10 3/8 x 27 1/2
Shipping Weight	72 lbs. Glass Included
Cord Length	75"

### WM-BI-43-5123 Designer

If you're looking for inspiration, our beveled steel faced fireplaces are the perfect fit. These stylish units feature a 45/45/90 degree, 1.5 inch return, adding dimension and richness to any room. Available in an assortment of the latest designer colours. Comes with log set and three colours of fire glass media. The WM-BI-43-5123 is designed to be wall mounted or built-in. *Architects Gray shown to the left.*

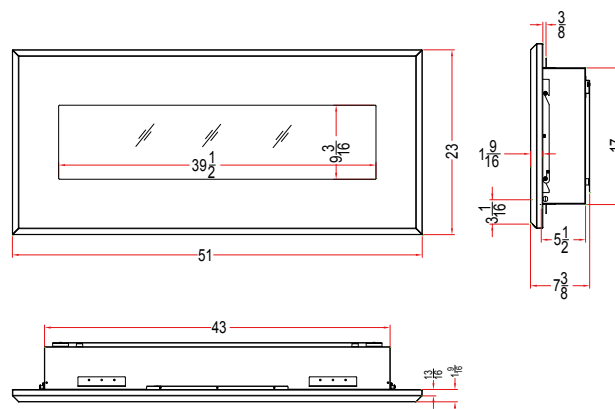



inspire



WM-BI-43-5123 Designer Electric Fireplace shown in Gallery White with log set

## 43" WM-BI DESIGNER SERIES COLOUR OPTIONS

(Colours are available for WM-BI-43-5123 Designer model only)

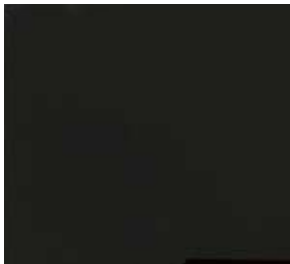

Matte Black



Modern Auburn

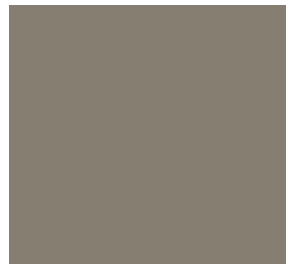

Architects Gray

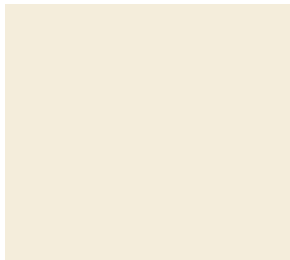

Gallery White



Candy Apple Red



Coastal Blue

Variations in colour and shade are inherent in all printing processes, the actual colours may vary slightly from those shown in this brochure. Please visit your local dealer to view a sample.

**Beveled Edges** - Our designer steel fronts are 1-1/2" thick, adding richness and beauty.



(Coastal Blue edge shown)

WM-38 Electric Fireplace with optional Dark Gray Limestone



WM-58 Electric Fireplace shown with optional Honey Travertine

# WM-58 SPECIFICATIONS



## Sleek & Stylish.

It's not easy being popular, but the WM 58" electric fireplace is all that and more. Fitting perfectly into any setting, this gorgeous fireplace will provide years of enjoyment and beauty in your home. Also available with real stone optional upgrades.

Volts	120
Amps	14.5
Watts	1745 max
Heater	1500 watts high, 750 watts low
No Heater	245 watts
Lamps	5 each 40 watt Candelabra Incandescent, 200 watts total
Rotor Motor	1 at 5 watts
Height, Width, Depth	20 1/10 x 39 3/10 x 5 3/10
Glass Viewing Opening	37" x 10"
Glass Size	58 1/4 w x 25 9/16 h
Shipping Size	
Glass Front Model	60 1/4 x 8 x 27 1/4
Stone Front Model	62 1/2 x 9 3/4 x 31 1/2
Shipping Weight	
Glass Front Model	106 lbs.
Stone Front Model	126 lbs.
Cord Length	75"

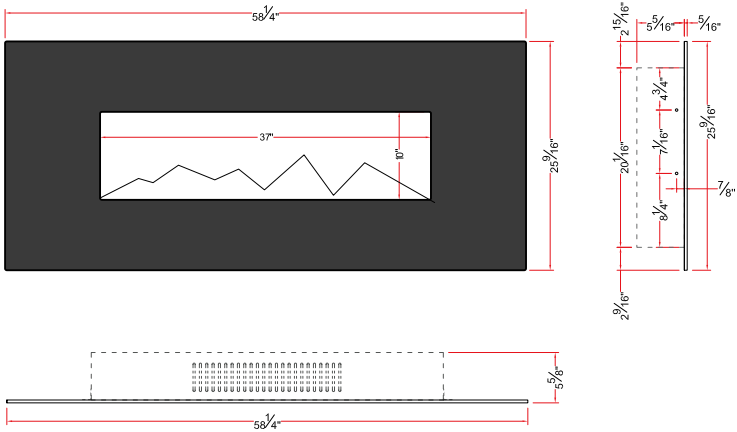



# REAL STONE FACE UPGRADES



WM-58 Electric Fireplace with optional Black Granite

## REAL STONE COLOUR OPTIONS

(Available in WM 38" and 58" models only)



Absolute Black Granite



Dark Gray Limestone



Honey Travertine

WM-58 Electric Fireplace shown with optional Dark Gray Limestone surround



# DESIGNER SERIES WALL MOUNT INCANDESCENT LIGHT WITH HEATER AND FAN



WM-62 Electric Fireplace shown  
with Metallic Black face

## WM-62 SPECIFICATIONS

### WALL MOUNT SERIES Fireplace Features

- 16 gauge steel fronts featuring a 45/45/90 degree return with welded corners, sanded, dipped and coated. This equals a 1.5 inch return and gives the product a very rich feel.
- Slim 6" depth unit hangs easily on any wall.
- Easy-to-install 2-step process.
- A lifelike flame that adds warmth and style to any setting.
- Flame operates with or without heat.
- Remote control for variable heat and variable flame (included).
- On demand heat - great for zone heating.
- 120 Volt - 1500 watt/5000 btu heater.
- Approximate heating area - 400 sq. ft.
- Easy to reach manual controls.
- Plug located on the right side.
- Fireplace ships in two boxes: one for the unit and one for the front face.



Volts	120
Amps	14.5
Watts	1745 max
Heater	1500 watts high, 750 watts low
No Heater	245 watts
Lamps	5 each 40 watt Candelabra Incandescent, 200 watts total
Rotor Motor	1 at 5 watts
Height, Width, Depth	20 1/16 x 39 3/10 x 5 5/16
Glass Viewing Opening	37 w x 9 4/5 h
Steel Surround	62 w x 24 3/10 h
Unit Shipping Size	60 x 8 x 28
Front Shipping Size	65 x 4 x 27
Total Shipping Weight	75 lbs. Front Included
Cord Length	75"

### Sleek & Stylish.

Fitting perfectly into any setting, the WM-62 is beautiful in any room. Comes in Textured Black or Metallic Black, also available in two contemporary colours. (Metallic Black face shown to the left) Note the black metallic front can be painted easily for up to 30 different colours, talk to your local hearth store.

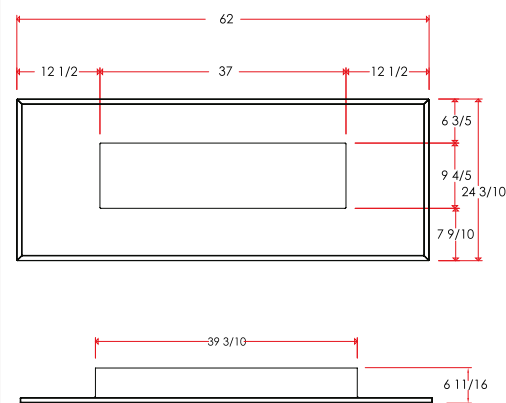





WM-62 Electric Fireplace shown with Coastal Blue face

## 62" & 102" DESIGNER SERIES COLOUR OPTIONS

### Classic Colours:

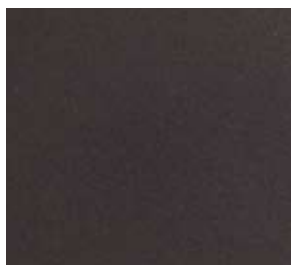

Metallic Black



Textured Black - Has the look of textured black leather.

(Metallic Black and Textured Black are available for WM-62", BLT-IN-62" and WM-102" models)

**Contemporary Colours:** Brighten up any room with a vivid, colourful fireplace. Our striking contemporary colours are available in the 62" model only and come in Candy Apple Red and Coastal Blue.



Candy Apple Red



Coastal Blue

(Contemporary colours are available for WM-62" and BLT-IN-62" models only)

**Beveled Edges** - Our designer steel fronts are 1-1/2" thick, adding richness and beauty.



(Metallic Black edge shown)



(Coastal Blue edge shown)





WM-102 Electric Fireplace shown with Metallic Black face

*luminous*

## WM-102 SPECIFICATIONS



### Breathtaking & Unique.

With an amazing length of 102", the WM-102 beveled electric fireplace is bound to turn heads. Comes in a Metallic Black finish.

Volts	120
Amps	15.5
Watts	1865 max
Heater	1500 watts high, 750 watts low
No Heater	365 watts
Lamps	9 each 40 watt Candelabra Incandescent, 360 watts total
Rotor Motor	1 at 5 watts
Height, Width, Depth	19 11/16 x 81 1/16 x 4 13/16
Glass Viewing Opening	76 3/5 w x 9 4/5 h
Steel Surround	102 w x 31 4/5 h
Unit Shipping Size	97 x 9 x 29
Front Shipping Size	105 x 4 x 35
Total Shipping Weight	247.5 lbs. Front Included
Cord Length	62"

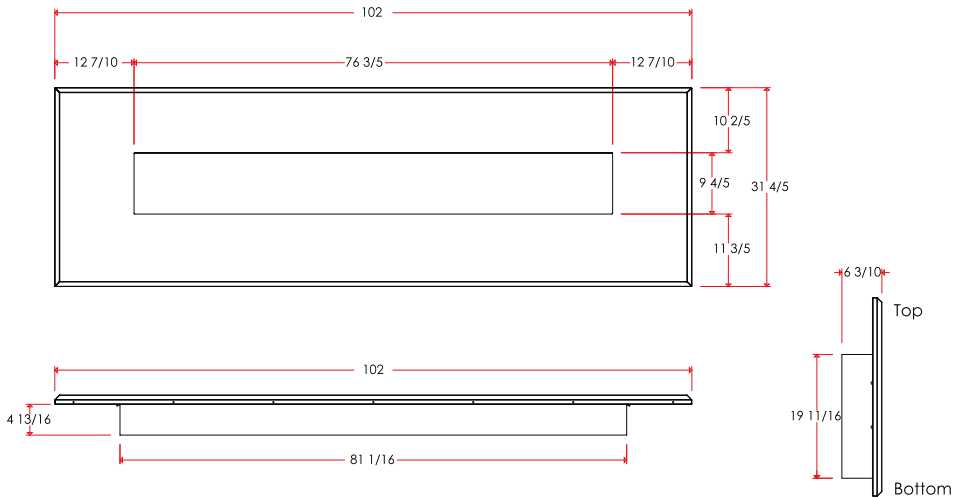

# BUILT-IN SERIES - REAL STONE

LED LIGHT  
NO HEATER, NO FAN



BLT-IN-38 Electric Fireplace with Dark Gray Limestone and optional Sable fire glass

## BLT-IN-38 SPECIFICATIONS

### BLT-IN SERIES

#### Fireplace Features

- 38" and 58" can be built-in or wall mount.
- Featuring LED light technology
- No heater
- No fan
- Unit can be built into the wall with 2 3/4" (7cm) protruding into the room
- 2 1/2" return on all Stone faced units
- Slim 6" overall depth unit mounts directly on any wall
- 12 Volt
- Remote control for turning the flame on or off (included)
- Easy to reach manual controls
- BLT-IN-38 & BLT-IN-58 come with three colours of fire glass media



Built-in electric fireplaces are a perfect alternative for gas or wood-burning fireplaces, solving impossible installation challenges and offering immediate gratification with same-day installation. This fireplace offers the convenience of either being a built-in or wall mount unit.

If you have limited space, then the BLT-IN 38" is your answer. This easy-to-install unit adds a clean, fresh look to any room in your home. Create your own style with the real stone. Three colours of fire glass media are included, see page 24.

*Honey Travertine stone shown to left.*

Volts	12
Amps	0.2
Watts	10.5
LED Lights	3 each 5 watt 15 watts total
Rotor Motor	1 at 5 watts
Height, Width, Depth	16 5/8 x 24 1/2 x 7 3/8
Glass Viewing Opening	20 3/4 x 11 1/4
Glass Size	38 w x 25 5/8 h
Shipping Size	42 1/2 x 9 3/4 x 31 1/2
Shipping Weight	96 lbs.
Cord Length	76"

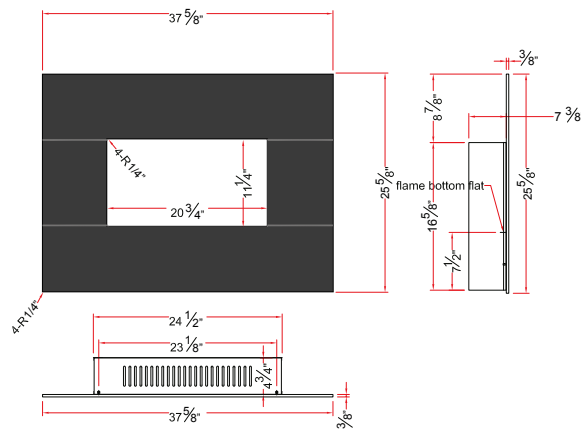

Units can be built into the wall with only 2 3/4" protruding into the room  
Stone face models have a 2 1/2" return on all four sides





BLT-IN-58 Electric Fireplace with Absolute Black Granite and optional Blaze fire glass

# BLT-IN-58 SPECIFICATIONS



## Sleek & Stylish.

It's not easy being popular, but the BLT-IN-58" electric fireplace is all that and more. Fitting perfectly into any setting, this gorgeous fireplace will provide years of enjoyment and beauty in your home. Available in three choices of real stone. **The BLT-IN 58 offers the convenience of either being a built-in or a wall mount unit.** Our new selection of three colours of fire glass media are included, see page 24. *Dark Gray Limestone shown to left.*

Volts	12
Amps	0.2
Watts	10.5
LED Lights	5 each 5 watt 25 watts total
Rotor Motor	1 at 5 watts
Height, Width, Depth	16 5/8 x 39 3/8 x 7 3/8
Glass Viewing Opening	38 x 11
Glass Size	58 1/4 w x 25 1/2 h
Shipping Size	62 1/2 x 9 3/4 x 31 1/2
Shipping Weight	128 lbs.
Cord Length	76"

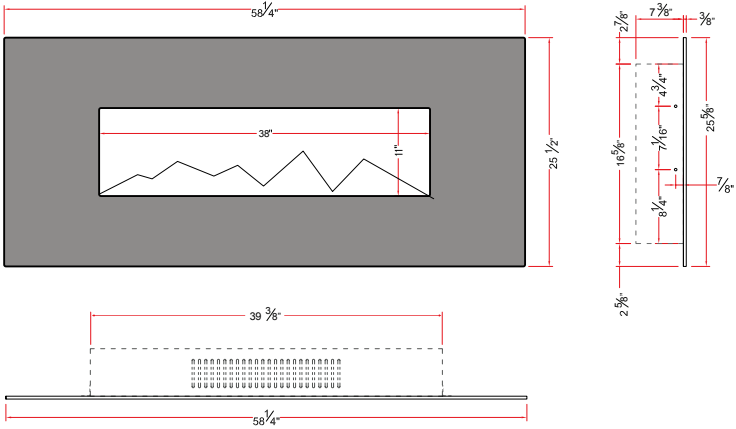

Units can be built into the wall with only 2 3/4" protruding into the room  
Stone face models have a 2 1/2" return on all four sides





BLT-IN-58 Electric Fireplace with Honey Travertine and optional Sunset Orange fire glass



BLT-IN-38 Electric Fireplace with Absolute Black Granite and Harvest Moon fire glass



# DESIGNER SERIES BUILT-IN

LED LIGHT  
NO HEATER, NO FAN



BLT-IN-62 Electric Fireplace shown with Textured Black face with optional Blaze fire glass

## BLT-IN-62 SPECIFICATIONS

### BUILT-IN SERIES Fireplace Features

- Can be built-in or wall mount
- 16 gauge steel fronts featuring a 45/45/90 degree return with welded corners, sanded, dipped and coated. This equals a 1.5 inch return and gives the product a very rich feel.
- BLT-IN-62 comes with three colours of fire glass media
- Featuring LED light technology
- No heater
- No fan
- Unit can be built into the wall with only 2" (5 cm) protruding into the room
- Slim 6" overall depth unit mounts directly on any wall
- 12 Volt
- Remote control for turning the flame on or off (included)
- Easy to reach manual controls
- Fireplace ships in two boxes: one for the unit and one for the front face



Volts	12
Amps	0.2
Watts	10.5 max
LED Lights	5 each 5 watt 25 watts total
Rotor Motor	1 at 5 watts
Length, Width, Depth	16 5/8 x 39 3/8 x 7 3/8
Glass Viewing Opening	37 w x 9 7/8 h
Steel Surround	62 w x 24 3/8 h
Unit Shipping Size	60 x 10 1/2 x 28
Front Shipping Size	65 x 4 x 27
Total Shipping Weight	75 lbs. Front Included
Cord Length	75"

### Impressive & Clean.

The BLT-IN-62" electric fireplace comes in Textured Black or Metallic Black, also available in two contemporary colours, Candy Apple Red and Coastal Blue, see page 32. **The BLT-IN 62 offers the convenience of either being a built-in or a wall mount unit.** Our selection of three colours of fire glass media are included, see page 24.

(Textured Black face shown to the left)

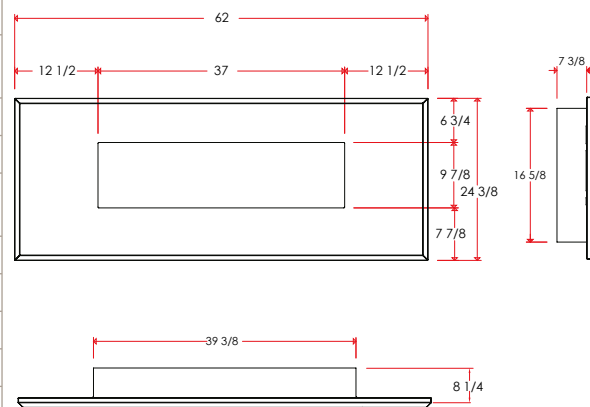

Unit can be built into the wall with only 1 1/2" protruding into the room





BLT-IN-62 Electric Fireplace shown with Coastal Blue face and optional Goldenrod fire glass



BLT-IN-62 Electric Fireplace shown with Candy Apple Red face and Harvest Moon fire glass

# ARTISAN SERIES

LED LIGHT  
NO HEATER, NO FAN



BLT-IN-5124 Electric Fireplace in Venetian Grey colour, Classico finish concrete face with optional Sable fire glass

## BLT-IN-5124 SPECIFICATIONS

### BLT-IN 5124 SERIES Fireplace Features

- Can be built-in or wall mount
- Featuring LED light technology
- No heater
- No fan
- Surround can be nearly flush against the wall
- 12 Volt
- Remote control for turning the flame on or off (included)
- Easy to reach manual controls
- Comes with three colours of fire glass media



Volts	12
Amps	0.2
Watts	10.5
LED Lights	5 each 5 watt 25 watts total
Rotor Motor	1 at 5 watts
Height, Width, Depth	16 5/8 x 39 3/8 x 6 5/8
Glass Viewing Opening	37 w x 10 h
Concrete Surround	51 w x 24 h x 3-3/8 d
Shipping Size	
Unit	40 x 7 x 22
Concrete Front	55 x 6 x 27
Shipping Weight	
Unit	27 lbs.
Concrete Front	90 lbs.
Plug Location	Right Side
Cord Length	76"

### Enduring & Unique.

Amantii's realistic flame and larger flame viewing area are standard for this 51" unit. The fireplace unit can be recessed into an opening leaving the 3-3/8" depth concrete face sitting nearly flush against the wall. Included in the box is our new selection of three colours of fire glass media. The BLT-IN-5124 is designed to be wall mounted or built-in.

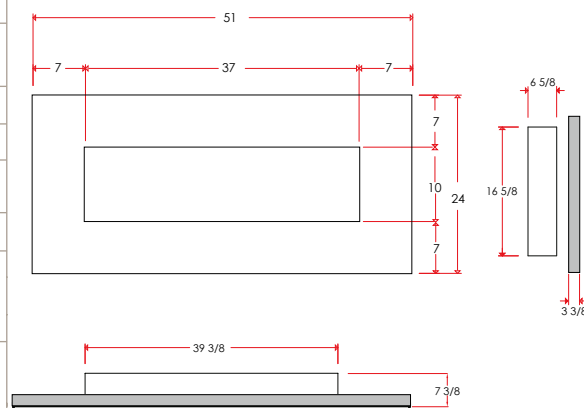

The fireplace unit can be recessed into an opening leaving the 3-3/8" depth concrete face sitting nearly flush against the wall. (There will be a 1/8" gap between the wall and the surround provided the unit is 2-3/4" out of the wall when installed)





BLT-IN-5124 Electric Fireplace in Tuscan Cream,  
Classico finish concrete face with Clear fire glass



BLT-IN-5124 Electric Fireplace in Venetian Grey, Moderno  
finish concrete face with optional Sunset Orange fire glass

# TIMELESS FINISH

Amantii is pleased to introduce our new line of hand-poured concrete surrounds. Our surrounds are beautiful to look at, transforming any space and providing years of enjoyment. Part of the unique quality of concrete is that textures and irregularities are part of its charm. As such it is not uncommon to find slight surface irregularities and colour variations from piece to piece. Each piece is cast by hand and the finest colour pigments have been used for the optimal in colour consistency. The Artisan surrounds are available in two styles; the Moderno and the Classico, and two colours; Venetian Grey and Tuscan Cream.



## ARTISAN CONCRETE FACE STYLE & COLOUR OPTIONS

### Styles:



Classico - Natural finish only



Moderno - Honed finish only

### Colours in each Finish:



Venetian Gray - Natural Finish



Tuscan Cream - Natural Finish



Venetian Gray - Honed Finish



Tuscan Cream - Honed Finish

*Variations in colour and shade are inherent in all printing processes, the actual colours may vary slightly from those shown in this brochure. Please visit your local dealer to view a sample.*



WM-50 Electric Fireplace with optional  
Frosted White glass face and Clear fire glass



WALL MOUNT

INCANDESCENT LIGHT - HEATER WITH FAN

## WM-1641 SPECIFICATIONS

### WM SERIES Vertical Convex Fireplace Features

- Crystal Black glass face
- Easy-to-install 2-step process
- State of the art electric flame technology for a realistic looking flame
- Flame operates with or without heat
- Remote control for flame and heater (included)
- On demand heat - great for zone heating
- 120 Volt - 1500 watt/ 5000 btu heater
- Approximate heating area - 500 sq. ft.
- Low operating cost with high (100%) efficiency
- Plug located on the right side



Volts	120
Amps	12
Watts	1435 max
Heater	1350 watts high, 675 watts low
No Heater	85 watts
Lamps	2 each 40 watt Candelabra Incandescent, 80 watts total
Rotor Motor	1@5 watts
Height, Width, Depth	39 3/8 x 10 3/8 x 6 1/4
Glass Viewing Opening	21 1/4 x 7 7/8
Glass Size	41 3/8 x 15 3/4
Shipping Size	19 x 9 x 43
Shipping Weight	49 lbs. Glass Included
Cord Length	76"

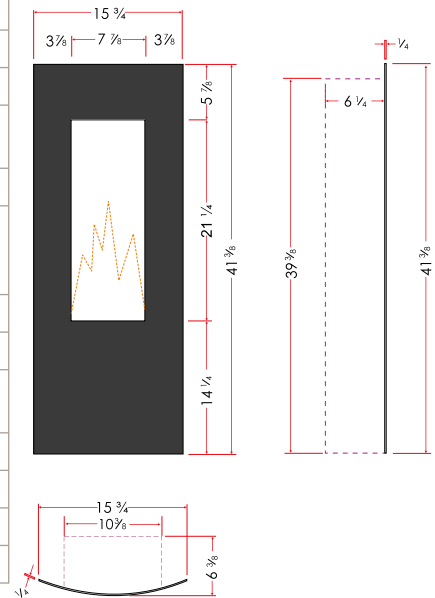

#### Vertical Convex Wall Mounted Electric Fireplace

The WM-1641 vertical convex electric fireplace can transform any space with its clean, contemporary design and realistic torch-like flame.

## WM-2134 SPECIFICATIONS



Volts	120
Amps	14
Watts	1435 max
Heater	1350 watts high, 675 watts low
No Heater	85 watts
Lamps	2 each 40 watt Candelabra Incandescent, 80 watts total
Rotor Motor	1@5 watts
Height, Width, Depth	26 7/9 x 14 5/9 x 4 4/5
Glass Viewing Opening	13 x 16 8/9
Glass Size	21 2/3 x 34 2/3
Shipping Size	24 x 9 x 36
Shipping Weight	46 lbs. Glass Included
Cord Length	70"

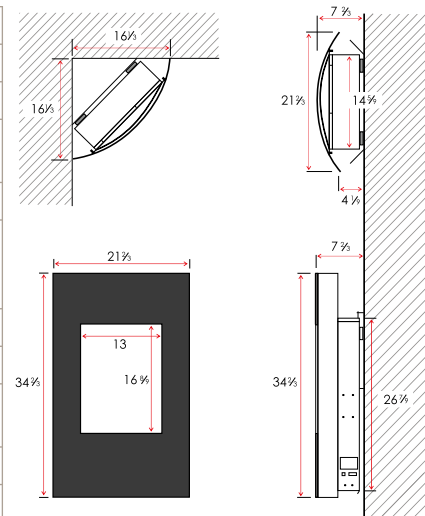

#### Vertical Convex Wall Mounted Electric Fireplace

Are you limited on space? This unique, vertical convex electric fireplace can be mounted flat against the wall or in a corner to make the most of a small area.



## WM-50 SPECIFICATIONS

### WM SERIES

#### Flat Front and Convex Fireplace Features

- Crystal Black glass
- Easy-to-install 2-step process
- WM-50 comes with three colours of fire glass media.
- WM-3522CF comes with rocks and three colours of fire glass media.
- A lifelike, adjustable flame that adds warmth and style to any setting
- Flame operates with or without heat
- Remote control for flame and heater (included)
- On demand heat - great for zone heating
- 120 Volt - 1500 watt/ 5000 btu heater
- Plug located on the right side



Log set

Volts	120
Amps	12.5
Watts	1500 max
Heater	1500 watts high, 800 watts low
No Heater	160 watts
Lamps	4 each 40 watts Candelabra Incandescent, 160 watts total
Rotor Motor	1 at 4 watts
Height, Width, Depth	18 1/10 x 38 3/5 x 5 3/10
Glass Viewing Opening	37 x 8 7/10
Glass Size	50 2/5 x 21 7/10
Shipping Size	54 x 26 x 9
Shipping Weight	52 lbs. Glass Included
Cord Length	75"



Frosted White shown with the ember bed

Add a little flare to your fireplace face with the WM-50. This unit has the option of a crystal black glass face or crystal frosted white glass face to fit your style. You'll also get the look of a beautiful wood fire, realistic log set and ember bed with this easy-to-install electric fireplace. Heats approximately 430 sq. ft. Comes with log set and three colours of fire glass media.

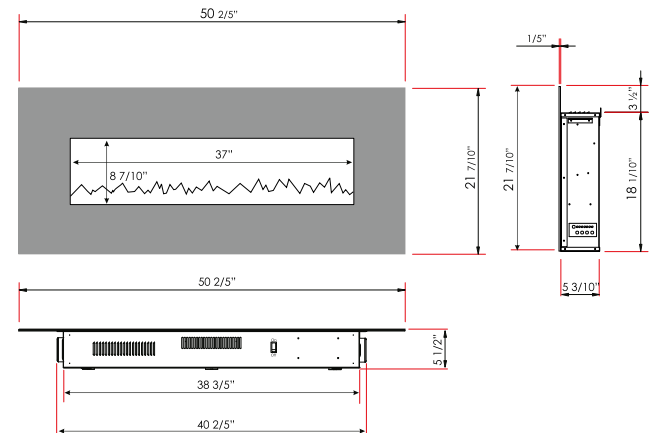

## WM-3522CF CONVEX FRONT SPECIFICATIONS



### Convex Front Wall Mounted Electric Fireplace

Set the mood with the WM-3522CF convex electric fireplace. With a realistic flame and modern design, this fireplace will add ambiance to any room. The WM-3522CF comes with rocks and three colours of fire glass media.

Approximate heating area - 376 sq. ft.

Volts	120
Amps	12.5
Watts	1500 max
Heater	1375 watts high, 625 watts low
No Heater	125 watts
Lamps	3 each 40 watt Candelabra Incandescent, 120 watts total
Rotor Motor	1@5 watts
Height, Width, Depth	18 3/5 x 22 1/10 x 5 3/10
Glass Viewing Opening	22 x 11 4/5
Glass Size	35 2/5 x 22 1/10
Shipping Size	38 x 8 x 25
Shipping Weight	47 lbs. Glass Included
Cord Length	75"

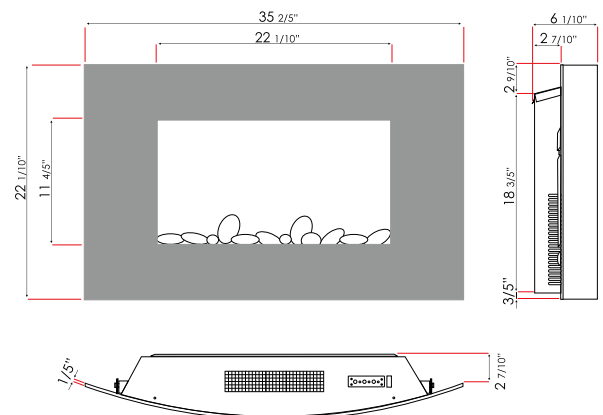



WM-38 Electric Fireplace

# WM-38 SPECIFICATIONS

## WM SERIES Liner Fireplace Features

- Comes standard with crystal black glass face
- Optional real stone faces are available for the WM-38 and WM-58
- Easy-to-install 2-step process
- Slim 6" depth unit hangs easily on any wall
- 2 1/2" return on all stone faced units
- A lifelike flame that adds warmth and style to any setting
- Flame operates with or without heat
- Remote control for variable heat and variable flame (included)
- On demand heat - great for zone heating
- 120 Volt - 1500 watt/5000 btu heater
- Approximate heating area - 400 sq. ft.
- Easy to reach manual controls
- Plug located on the right side



## Eco-friendly & Beautiful.

If you love the sleek appearance of a linear fireplace, but have limited space, the WM 38" is your answer. This easy-to-install unit adds a clean, fresh look to any room in your home. The crystal black glass face comes standard, or create your own style with optional real stone upgrades.

Volts	120
Amps	13.5
Watts	1625 max
Heater	1500 watts high, 750 watts low
No Heater	125 watts
Lamps	3 each 40 watt Candelabra Incandescent, 120 watts total
Rotor Motor	1 at 5 watts
Height, Width, Depth	19 1/8 x 24 1/2 x 4 3/4
Glass Viewing Opening	20 3/4 x 11 1/4
Glass Size	37 5/8 w x 25 5/8 h
Shipping Size	
Glass Front Model	39 3/4 x 7 1/2 x 27 1/4
Stone Front Model	42 1/2 x 9 3/4 x 31 1/2
Shipping Weight	
Glass Front Model	68.5 lbs.
Stone Front Model	92.75 lbs.
Cord Length	76"

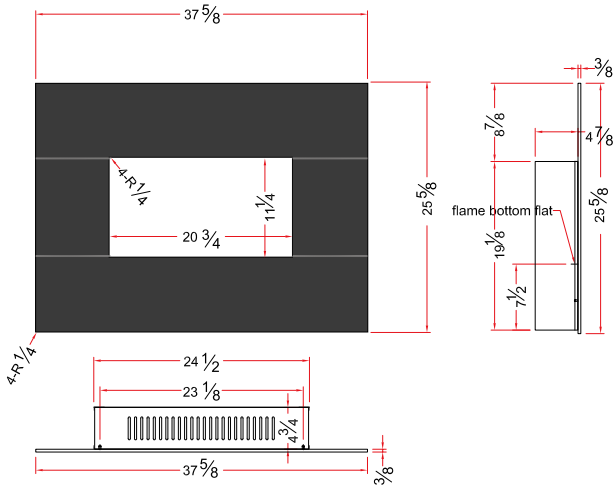





WM-58 Electric Fireplace

# WM-58 SPECIFICATIONS



## Sleek & Stylish.

It's not easy being popular, but the WM 58" electric fireplace is all that and more. Fitting perfectly into any setting, this gorgeous fireplace will provide years of enjoyment and beauty in your home. Also available with real stone optional upgrades.

Volts	120
Amps	14.5
Watts	1745 max
Heater	1500 watts high, 750 watts low
No Heater	245 watts
Lamps	5 each 40 watt Candelabra Incandescent, 200 watts total
Rotor Motor	1 at 5 watts
Height, Width, Depth	20 1/10 x 39 3/10 x 5 3/10
Glass Viewing Opening	37" x 10"
Glass Size	58 1/4 w x 25 9/16 h
Shipping Size	
Glass Front Model	60 1/4 x 8 x 27 1/4
Stone Front Model	62 1/2 x 9 3/4 x 31 1/2
Shipping Weight	
Glass Front Model	106 lbs.
Stone Front Model	126 lbs.
Cord Length	75"

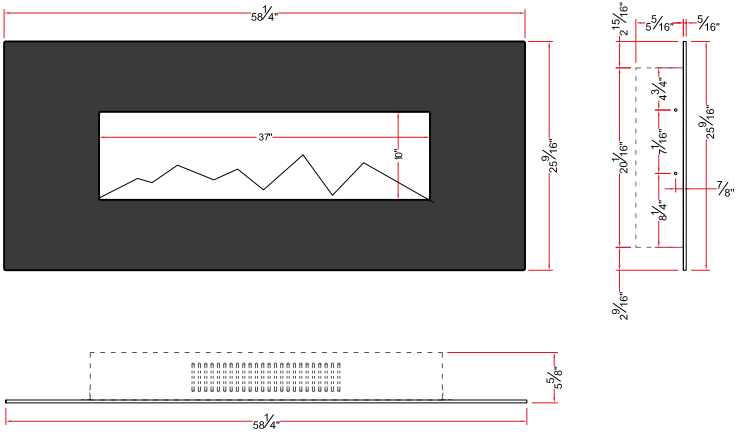



WM-95 Electric Fireplace

*wow factor*

## WM-95 SPECIFICATIONS



### Contemporary & Distinctive.

With its unique flame and stunning length, this WM 95" electric fireplace will certainly be a show-stopper, whether it's part of your home or business.

Volts	120
Amps	15.5
Watts	1865 max
Heater	1500 watts high, 750 watts low
No Heater	365 watts
Lamps	9 each 40 watt Candelabra Incandescent, 360 watts total
Rotor Motor	1 at 5 watts
Height, Width, Depth	19 7/10 x 81 1/10 x 4 4/5
Glass Viewing Opening	78 1/2 x 10 5/8
Glass Size	94 1/2 w x 26 3/8 h
Shipping Size	97 x 9 x 29
Shipping Weight	176.5 lbs. Glass Included
Cord Length	62"

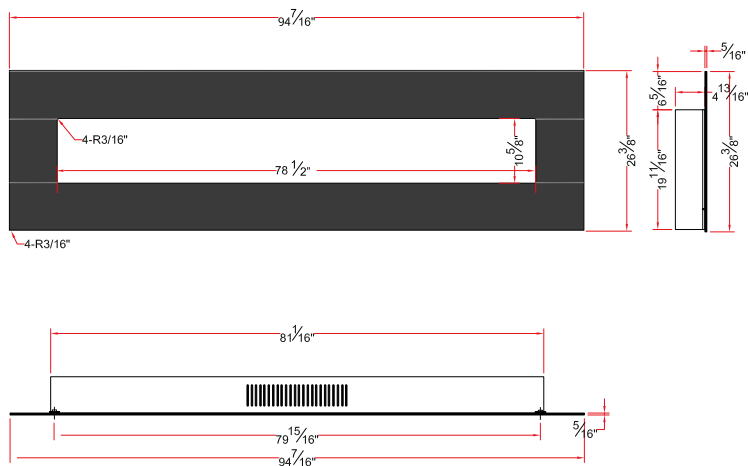





Phone: 888.406.8764  
Fax: 877.498.4206  
Web site: [www.amantii.com](http://www.amantii.com)



Distributed By:

