

# THE CUBE

## ELECTRIC FIREPLACE

*Amantii*



The stylish Cube 3 sided electric fireplace is truly innovative! The stunning flame presentation and unique media options can now be viewed from almost any angle through 3 sides of glass viewing area. With three distinct styles to choose from the Cube is perfect for any space, inside or out including bathrooms and kitchens.

### KEY FEATURES

- 3-sided built-in electric fireplace
- WiFi Compatible to connect and control the fireplace from your smartphone with the use of our app. Available on the Google Play Store and Apple App Store
- Three speed flame motor
- Heat output 5000 BTU
- No unsightly venting and grills seen. A true clean and vent free look
- Programmable timer & thermostat allows you to decide the temperature of the room. Set your fireplace to turn on before you arrive home or have it automatically turn on when the weather is cold.
- Touch pad for convenient control of the features and temperature display from the fireplace.
- Choose from combinations of yellow, orange and red colored flames
- Approved for indoor or outdoor applications.\*
- Choose from 11 colors of canopy and ember bed lighting to illuminate decorative media from below and above
- Two flame pattern styles – standard and more traditional
- New patented thermostatic remote comes included



ORANGE FLAME



YELLOW FLAME



RED FLAME

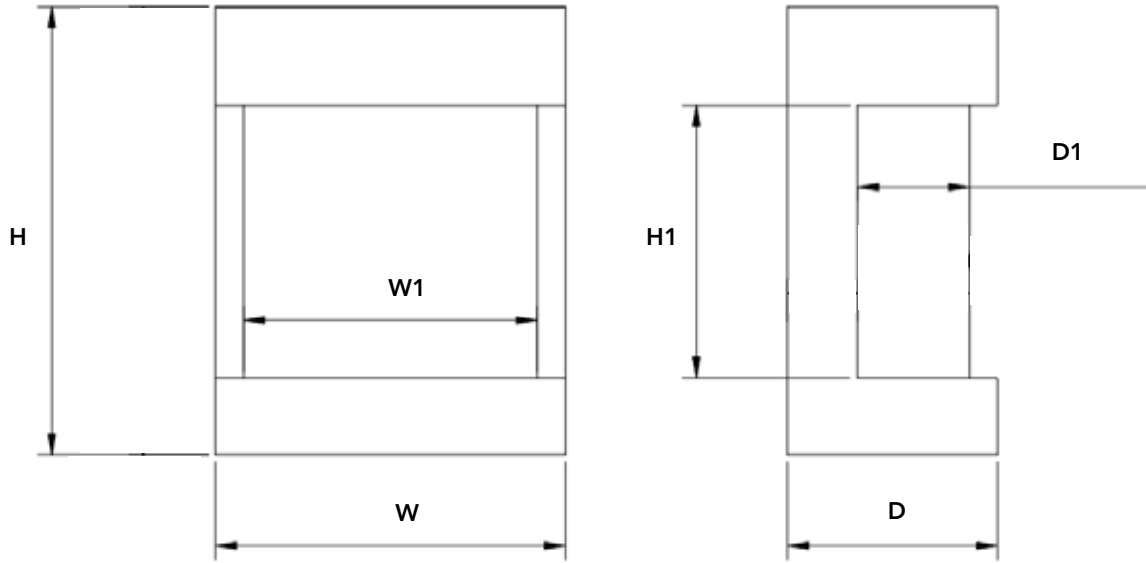

PRODUCT MODEL	W	H	D	W1	H1	D1
CUBE-2025WM	19 5/8" 50	25 1/4" 64.1	11 3/4" 30	16-1/2" 42	15-3/8" 39	6-1/4" 16.02

**INCLUDED ACCESSORIES**

Each unit comes with a 10 piece log set, charcoal grey real fireglass media and two bags of vermiculite, in black and white, and a remote.



AM-CUBE-SELL MARCH 2024

Distributed By:



Visit our online showrooms at:

[www.amantii.com](http://www.amantii.com)

Product updates, specifications and dimensions are subject to change. Please refer to the product manual to verify measurements and clearance requirements. All local building codes must be followed.