

# WM FM SERIES

Service the mood light

# Remove the front glass from the unit



1. Unscrew screws on both sides.

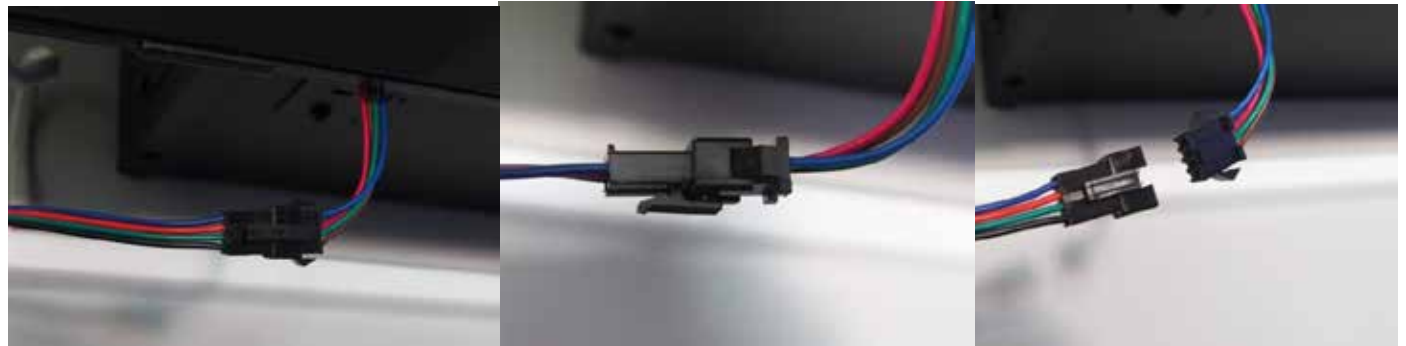

2. Unplug the moodlight plug from the unit.

3. Carefully lift and forward to take off the front glass.

\*IMPORTANT: on larger models two people will be required to remove and attach the glass surround.

# Replace the mood light strips



The mood lighting is made up of 4 strips, each strip can be replaced separately.

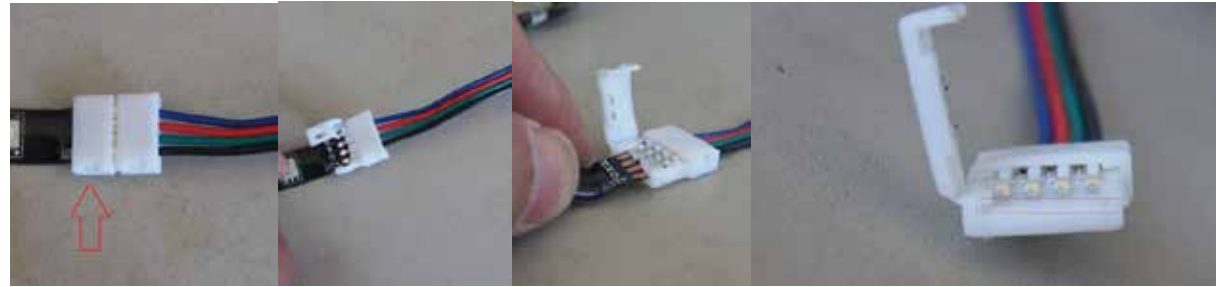

1. Loosen the mood light from the connector by opening the plastic clip as shown above.



2. Release and remove the plastic rivet as shown.

# Replace a corner connector

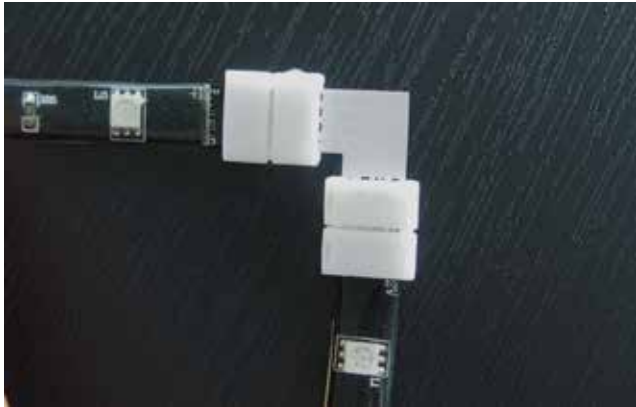

The corner connector

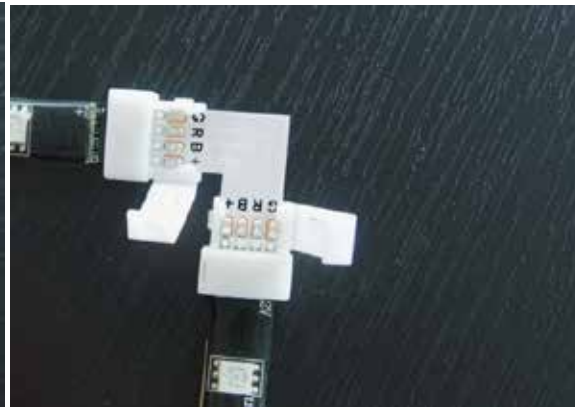

Release the white plastic clips on both ends of the corner connector.



Detach light strips from Corner connector

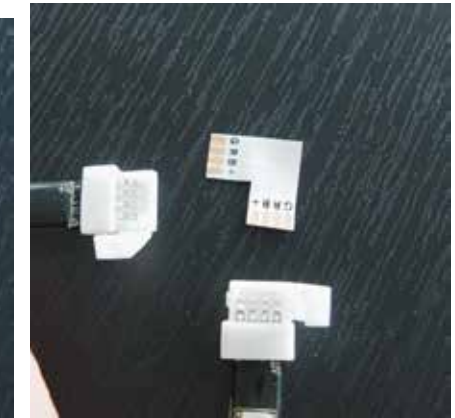

Replace corner connector and snap clips back in place.