

*Amantii*



# ELECTRIC FIREPLACE

[www.amantii.com](http://www.amantii.com)

## MAINTENANCE MANUAL

### MODEL:

LF2510048-1 (LF48),  
LF2510063-1 (LF63),  
LF2510075-1 (LF75)





# Contents

1. REPLACING CONTROL BOX.....	1
2. REPLACING DISPLAY SCREEN.....	3
3. REPLACING DOWN LIGHT ASSEMBLY.....	5
4. REPLACING EMBER BED LED BOARD.....	6
5. REPLACING EMBER BED MOTOR.....	8
6. REPLACING FLAME LED BOARD.....	10
7. REPLACING FLAME MOTOR.....	13
8. REPLACING HEATER/BLOWER ASSEMBLY.....	16

## Replacing Control Box for Luma Forest CSA

Please note all the operation need to be processed when the power is off, and keep the screws remove from the fireplace properly, you will need them when install the unit back.

1. Remove 2 ST4\*8 screws as shown in the below picture, and take off the front glass panel carefully.



2. Remove 4 ST4\*8 screws on the down light assembly, unplug the connection wire and remove the down light assembly.

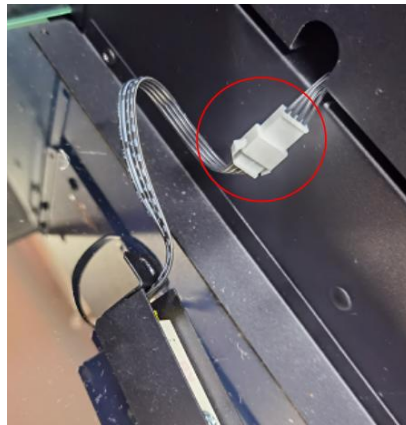
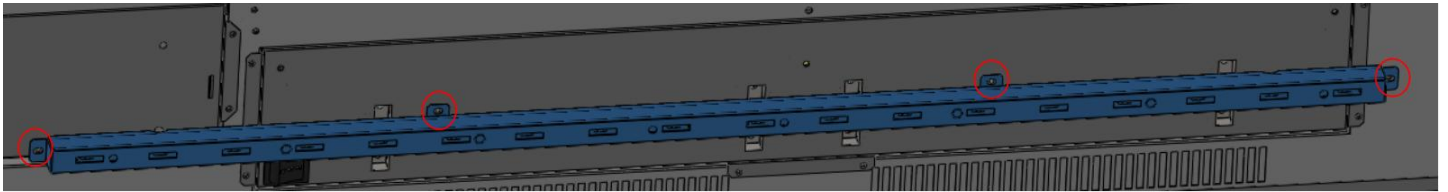

3. Remove 4 ST4\*8 screws on the control box, and take out the control box carefully. Unplug 12 connection wires as shown in the below picture and replace with a new control box.

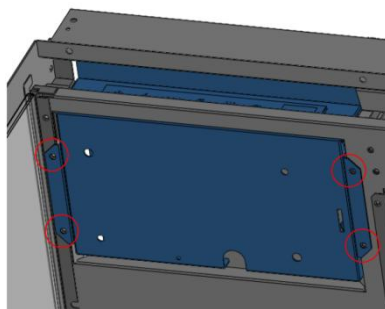

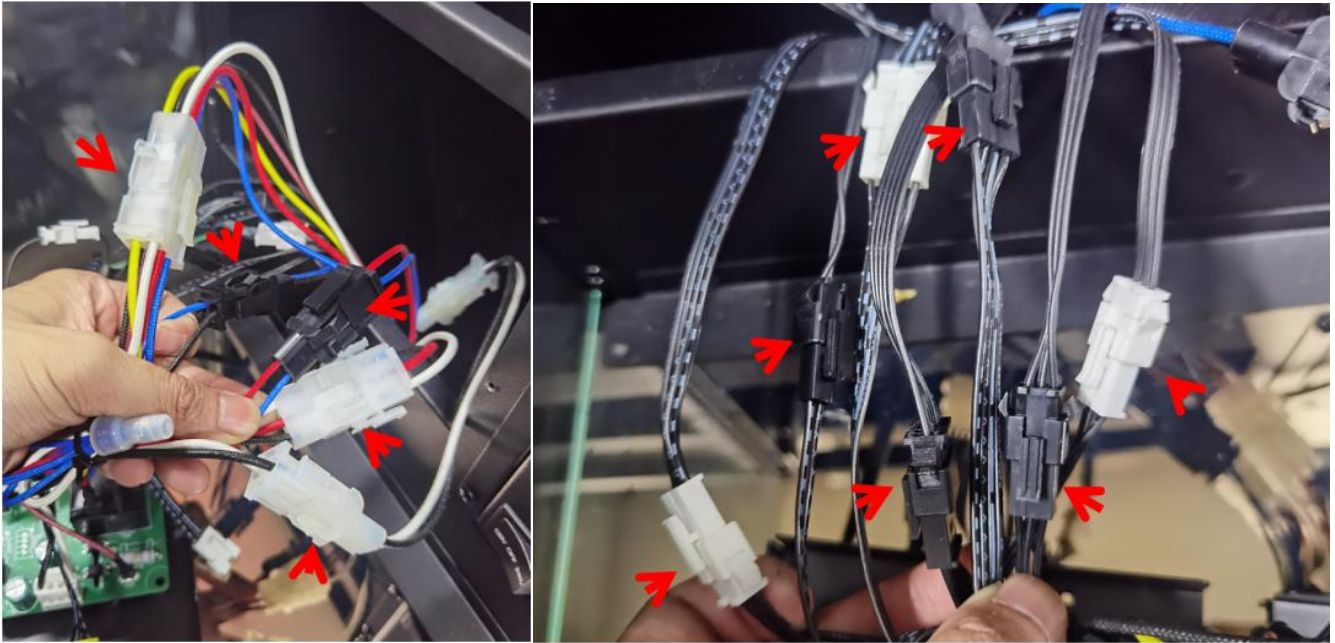

4. Install the fireplace back step by step.

## Replacing Display Screen for Luma Forest CSA

Please note all the operation need to be processed when the power is off, and keep the screws remove from the fireplace properly, you will need them when install the unit back.

1. Remove 2 ST4\*8 screws as shown in the below picture, and take off the front glass panel carefully.



2. Remove 12 screws on the ember bed, and take off the ember bed.

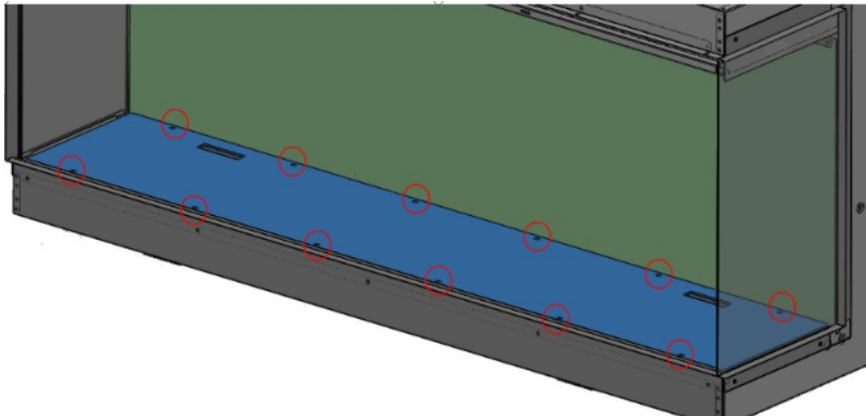

3. Remove the left fixing bracket for side glass panel, and use a suction cup lifter to remove the left side glass.

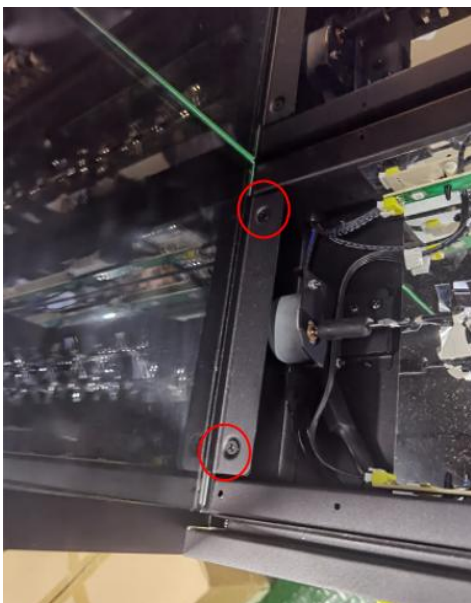

4. Carry out the same operation on the right side.

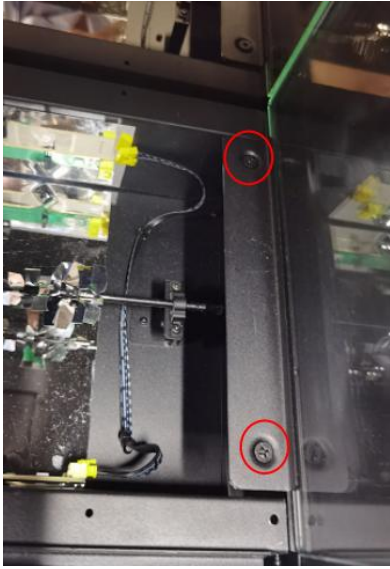

5. Remove 4 ST4\*8 screws on the down light assembly, unplug the connection wire and remove the down light assembly.

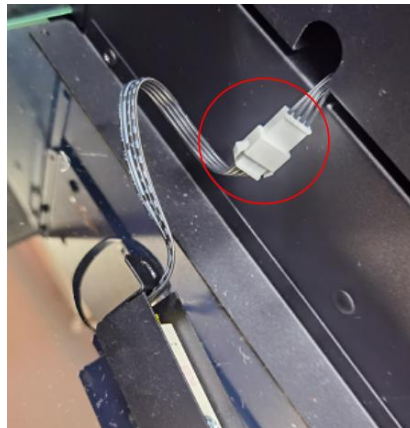
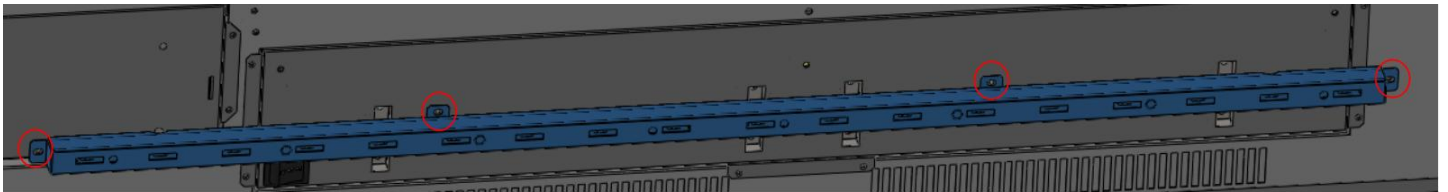

6. Remove the screws on the display screen bracket (5pcs for LF48 CSA, 7pcs for LF63 CSA, 8pcs for LF75 CSA), and use a suction cup lifter to replace the display screen.

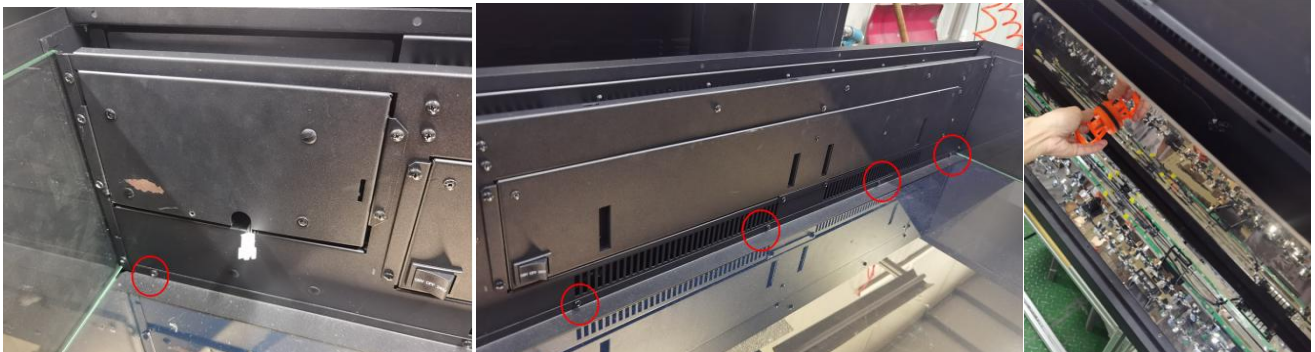

7. Install the fireplace back step by step.

## Replacing Down Light Assembly for Luma Forest CSA

Please note all the operation need to be processed when the power is off, and keep the screws remove from the fireplace properly, you will need them when install the unit back.

1. Remove 2 ST4\*8 screws as shown in the below picture, and take off the front glass panel carefully.



2. Remove 4 ST4\*8 screws on the down light assembly, unplug the connection wire and replace the down light assembly.

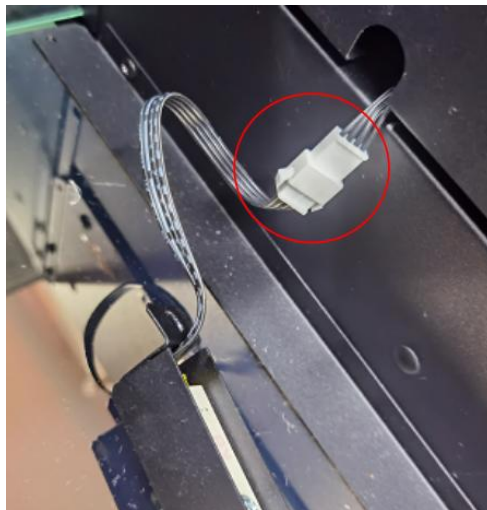
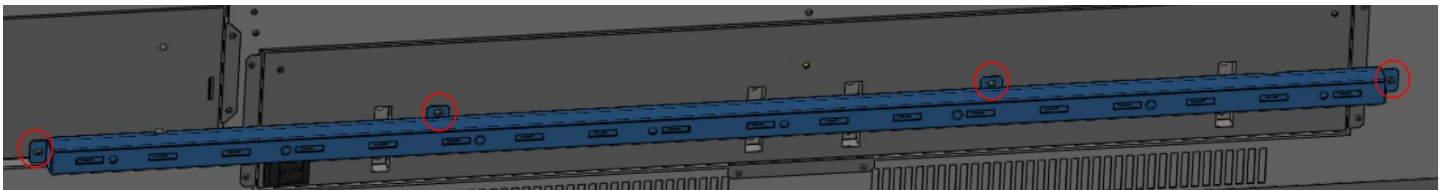

3. Install the fireplace back step by step.

## Replacing Ember Bed LED Board for Luma Forest CSA

Please note all the operation need to be processed when the power is off, and keep the screws remove from the fireplace properly, you will need them when install the unit back.

1. Remove 2 ST4\*8 screws as shown in the below picture, and take off the front glass panel carefully.



2. Remove 12 screws on the ember bed, and take off the ember bed.

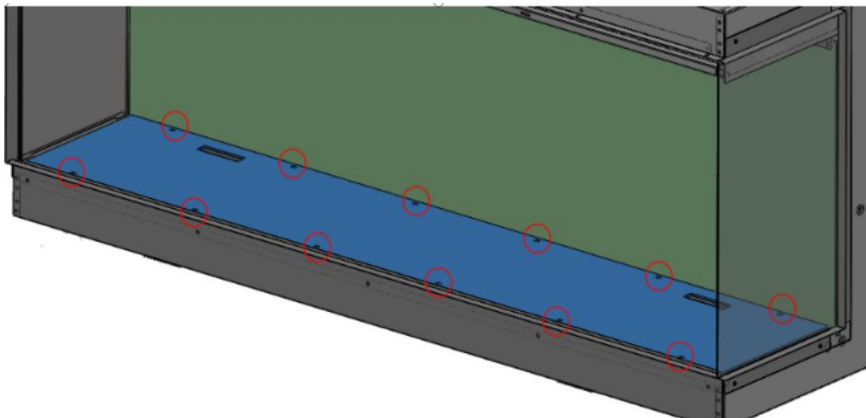

3. Remove the ember bed LED boards and replace with new ones, pay attention to the direction of the LED interface.

### A. 4 ember bed LED boards for LF48 CSA

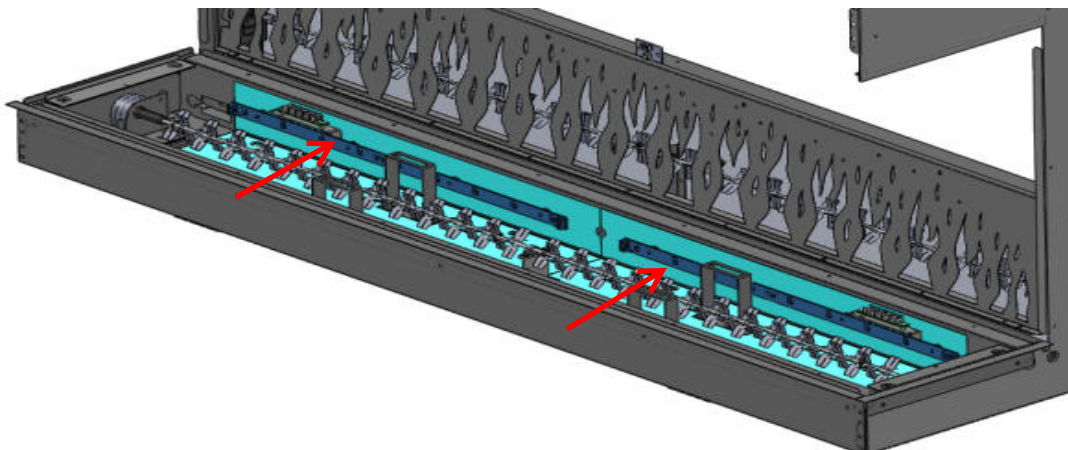

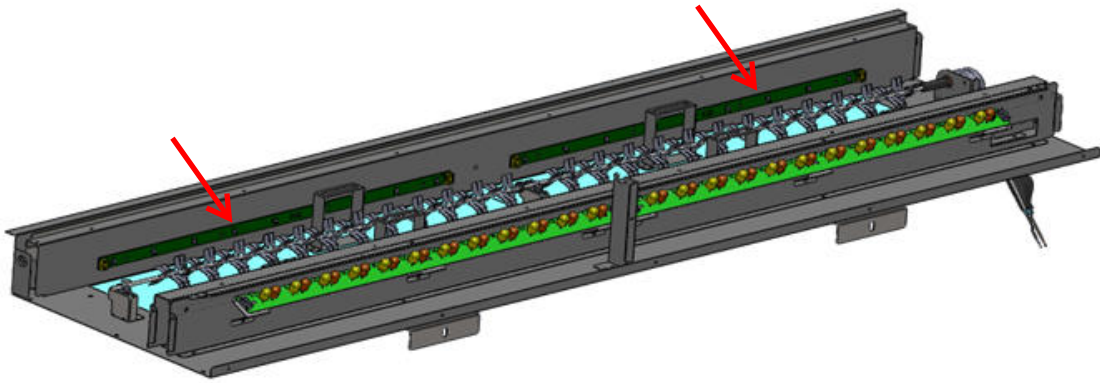

B. 6 ember bed LED boards for LF63 CSA and LF75 CSA

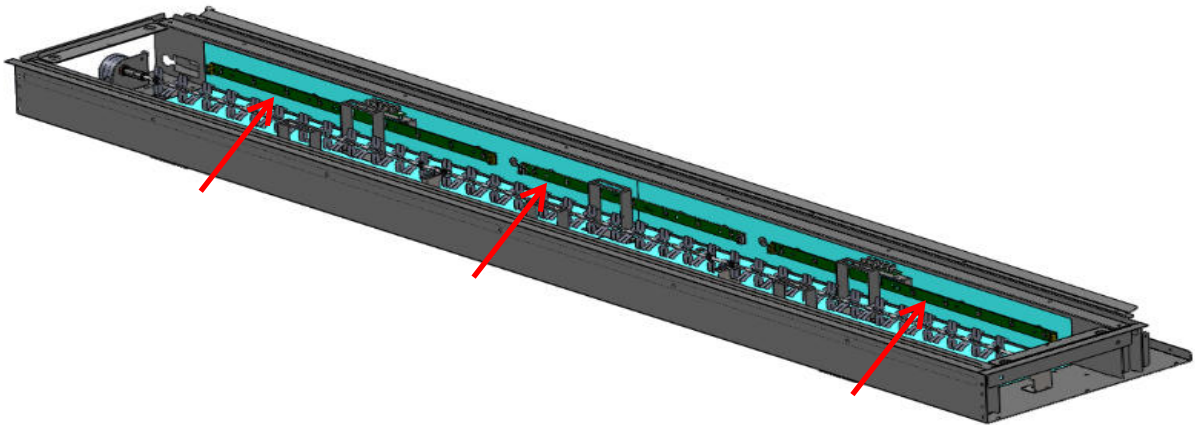
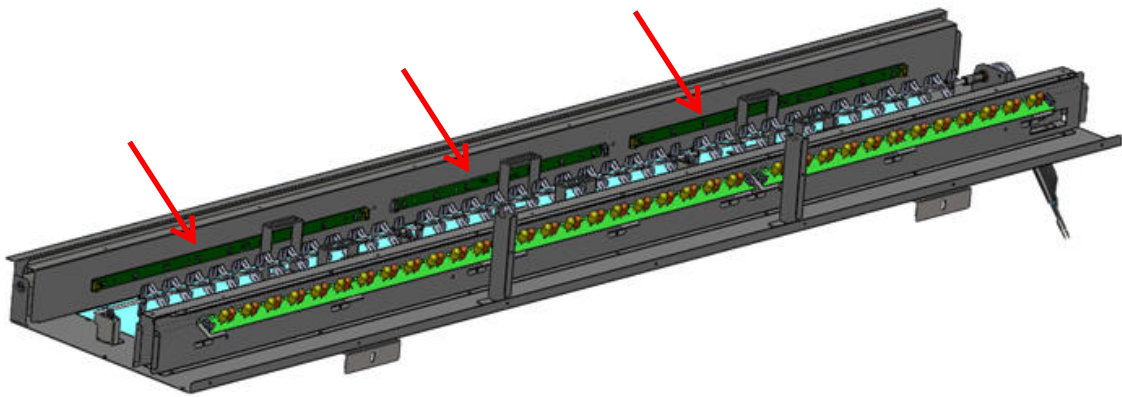

4. Install the fireplace back step by step.

## Replacing Ember Bed Motor for Luma Forest CSA

Please note all the operation need to be processed when the power is off, and keep the screws remove from the fireplace properly, you will need them when install the unit back.

1. Remove 2 ST4\*8 screws as shown in the below picture, and take off the front glass panel carefully.



2. Remove 12 screws on the ember bed, and take off the ember bed.

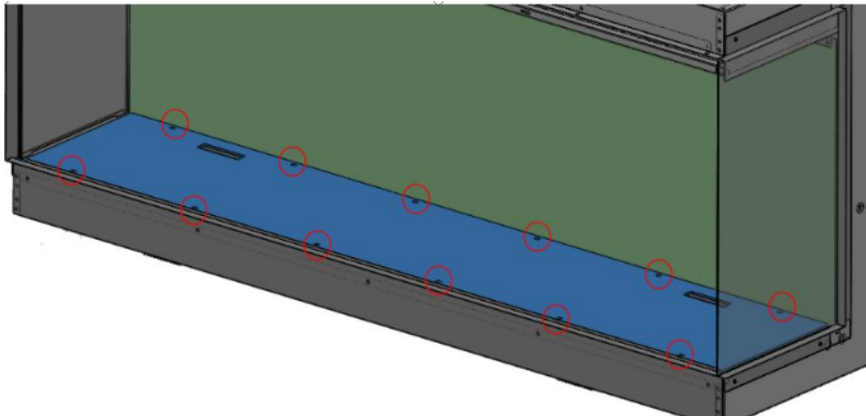

3. Remove ember bed flicker assembly, and 3 screws on the bracket as shown in the below picture. Unplug the connection wire for the ember bed motor.

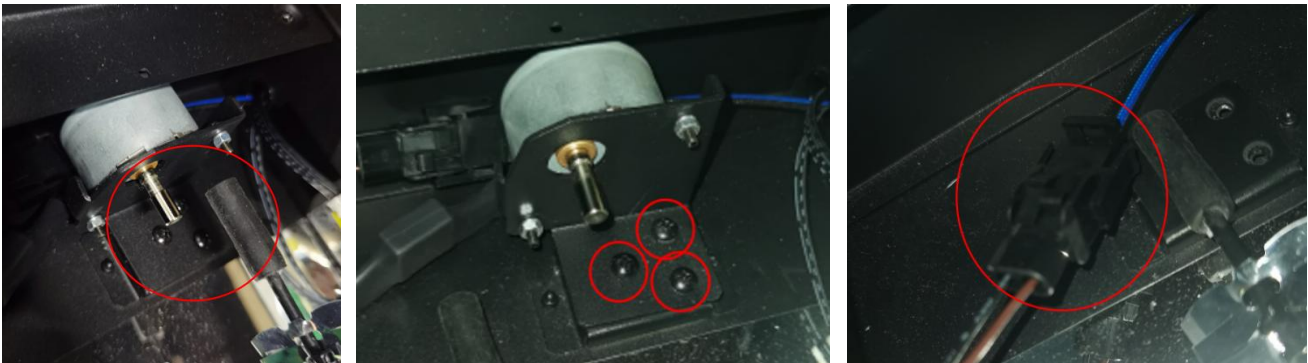

4. Replace with the new ember bed motor and plug the connection wire. Install the 3 screws back on the bracket, and tidy up the connection wire behind the ember bed motor as shown in the below picture.



5. Install the fireplace back step by step.

## Replacing Flame LED Board for Luma Forest CSA

Please note all the operation need to be processed when the power is off, and keep the screws remove from the fireplace properly, you will need them when install the unit back.

1. Remove 2 ST4\*8 screws as shown in the below picture, and take off the front glass panel carefully.



2. Remove 12 screws on the ember bed, and take off the ember bed.

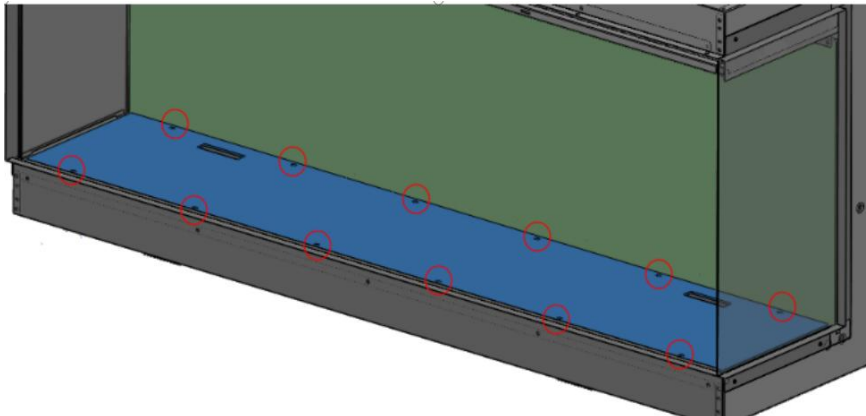

3. Remove the left fixing bracket for side glass panel, and use a suction cup lifter to remove the left side glass.

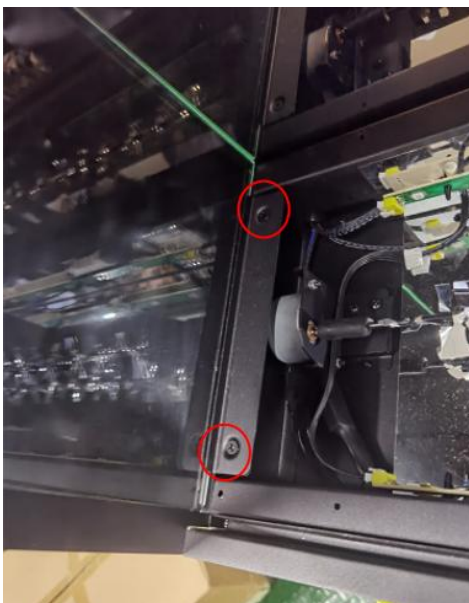

4. Carry out the same operation on the right side.

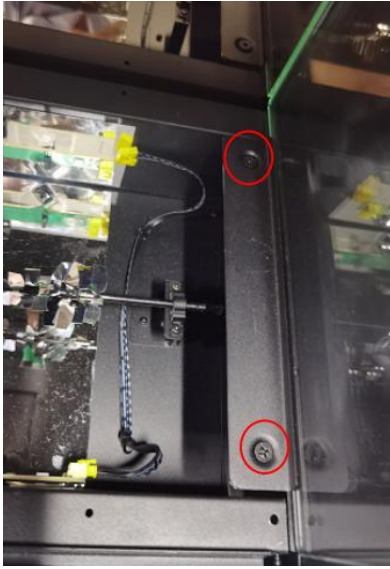

5. Remove 4 ST4\*8 screws on the down light assembly, unplug the connection wire and remove the down light assembly.

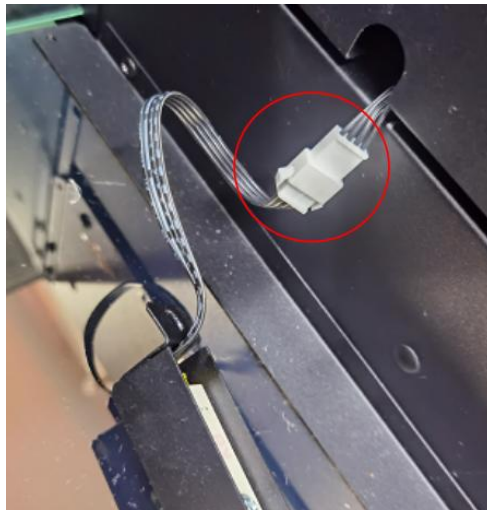
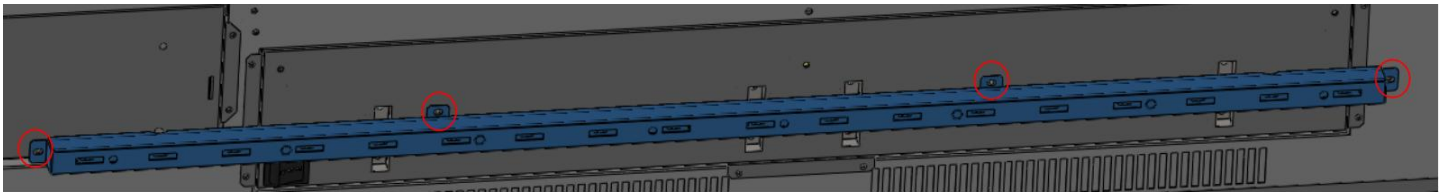

6. Remove the screws on the display screen bracket (5pcs for LF48 CSA, 7pcs for LF63 CSA, 8pcs for LF75 CSA), and use a suction cup lifter to remove the display screen.



7. Remove the screws on the flame stencil and take it off (9pcs for LF48 CSA, 13pcs for LF63 CSA, 14pcs for LF75 CSA).

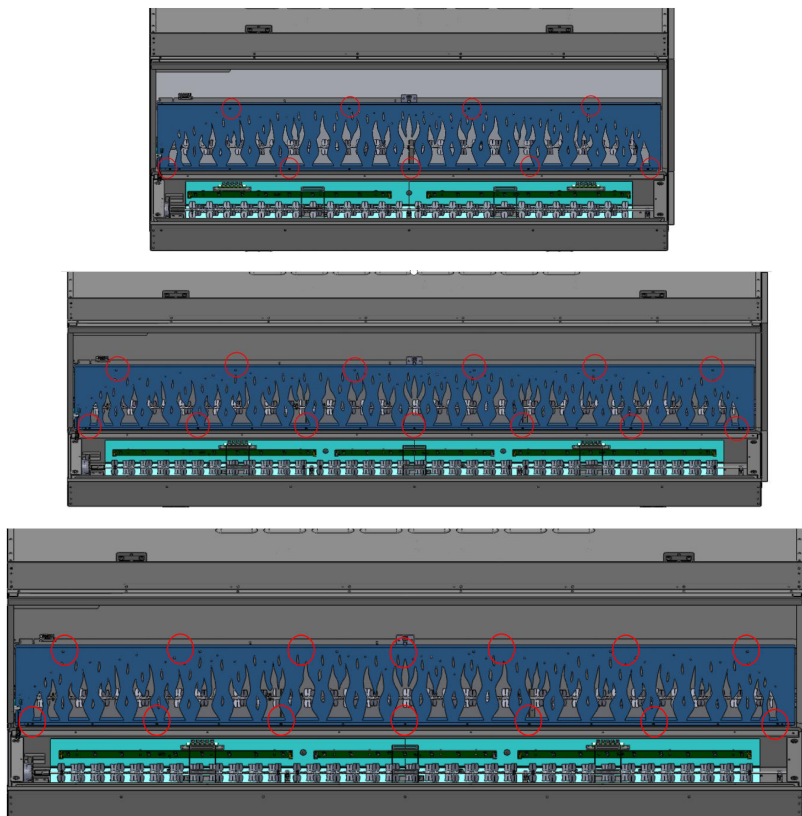

8. Replace the flame LED board with new one, pay attention to the direction of LED interface.

A. 2 flame LED boards for LF48 CSA

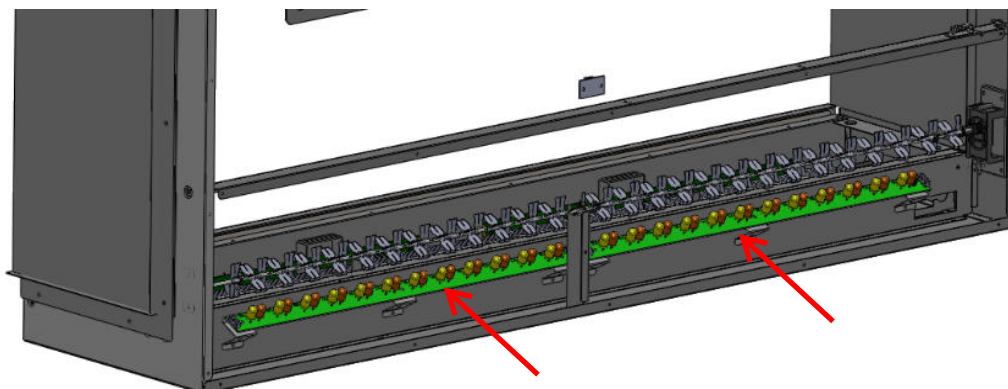

B. 3 flame LED boards for LF63 CSA and LF75 CSA

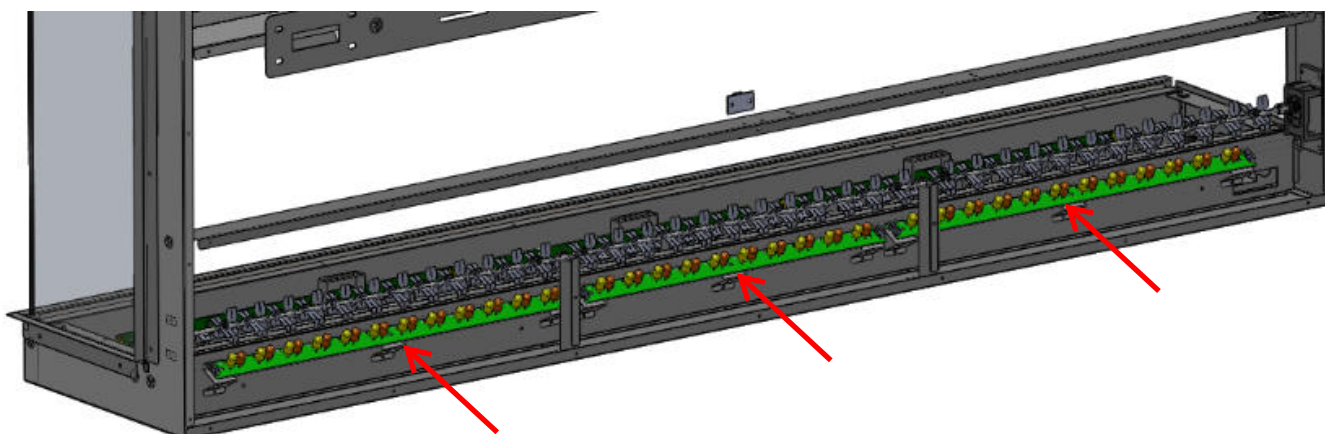

9. Install the fireplace back step by step.

## Replacing Flame Motor for Luma Forest CSA

Please note all the operation need to be processed when the power is off, and keep the screws remove from the fireplace properly, you will need them when install the unit back.

1. Remove 2 ST4\*8 screws as shown in the below picture, and take off the front glass panel carefully.



2. Remove 12 screws on the ember bed, and take off the ember bed.

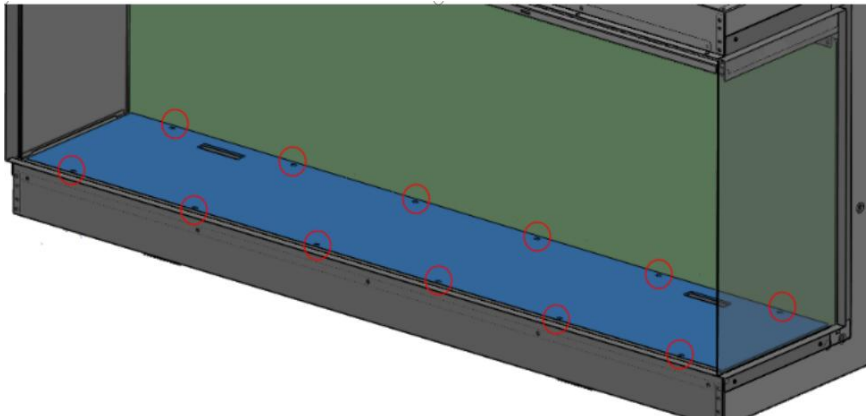

3. Remove the left fixing bracket for side glass panel, and use a suction cup lifter to remove the left side glass.

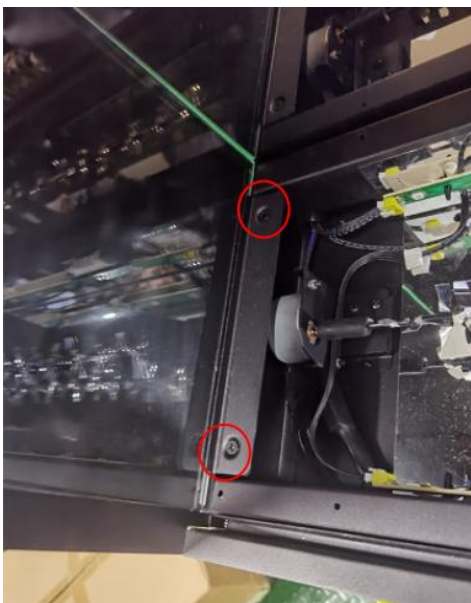

4. Carry out the same operation on the right side.

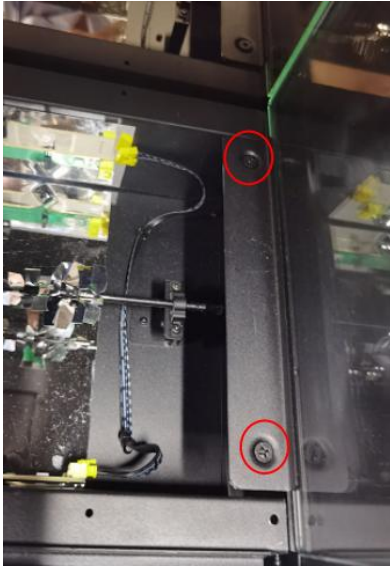

5. Remove 4 ST4\*8 screws on the down light assembly, unplug the connection wire and remove the down light assembly.

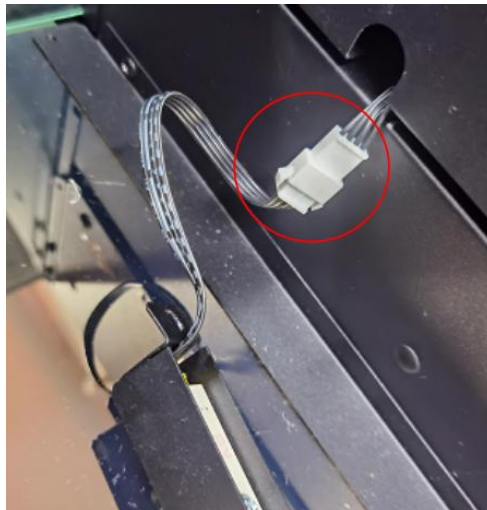
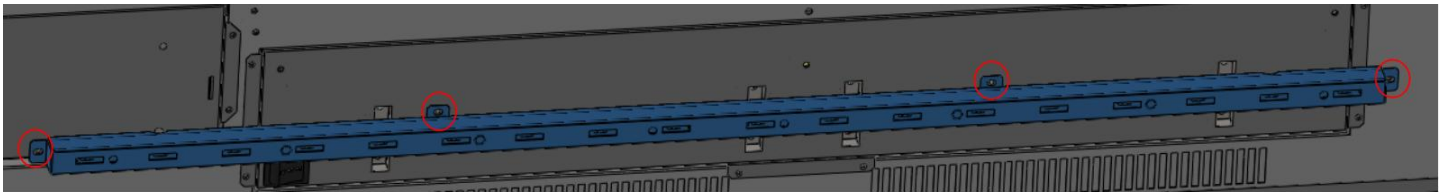

6. Remove screws on the display screen bracket (5pcs for LF48 CSA, 7pcs for LF63 CSA, 8pcs for LF75 CSA), and use a suction cup lifter to remove the display screen.

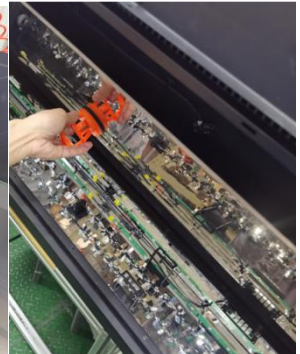
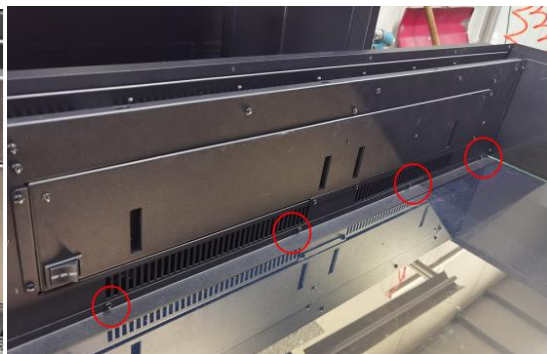

7. Remove the screws on the flame stencil and take it off (9pcs for LF48 CSA, 13pcs for LF63 CSA, 14pcs for LF75 CSA).

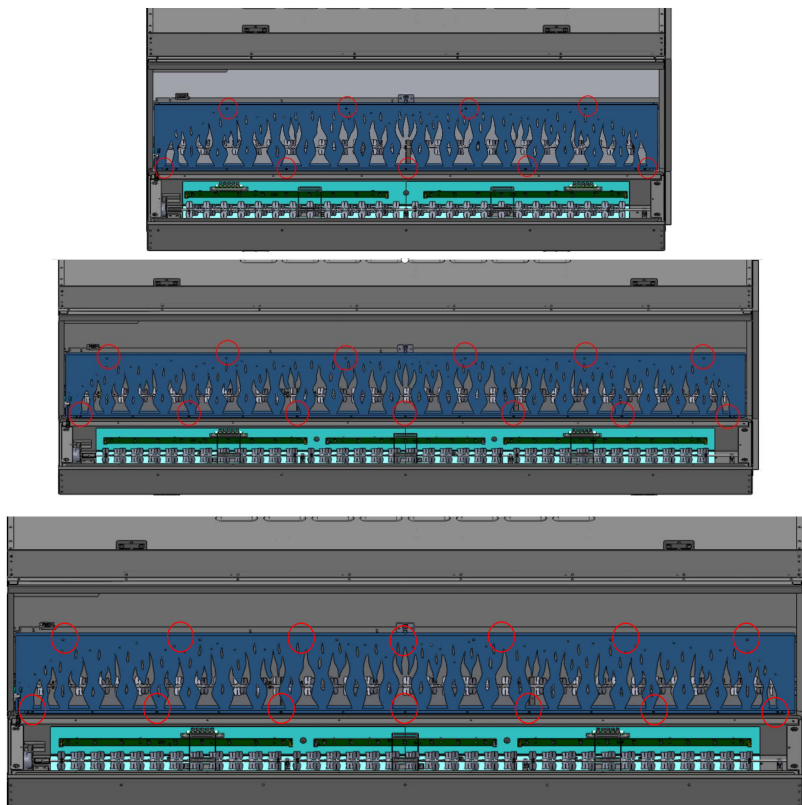

8. Remove the flame flicker assembly as shown in the below picture.

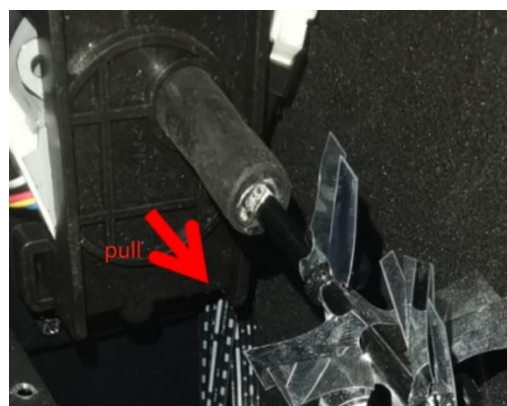
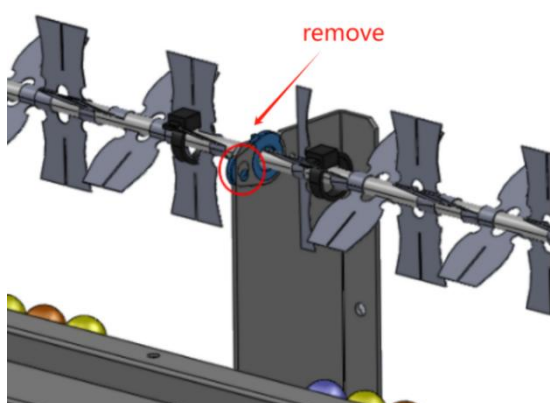

9. Remove 4 screws on the flame motor assembly, unplug the connection wire for the flame motor and replace with a new one.

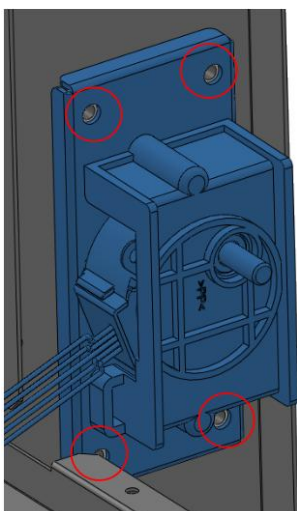

10. Install the fireplace back step by step.

## Replacing Heater/Blower Assembly for Luma Forest CSA

Please note all the operation need to be processed when the power is off, and keep the screws remove from the fireplace properly, you will need them when install the unit back.

1. Remove 2 ST4\*8 screws as shown in the below picture, and take off the front glass panel carefully.



2. Remove 4 ST4\*8 screws on the down light assembly, unplug the connection wire and remove the down light assembly.

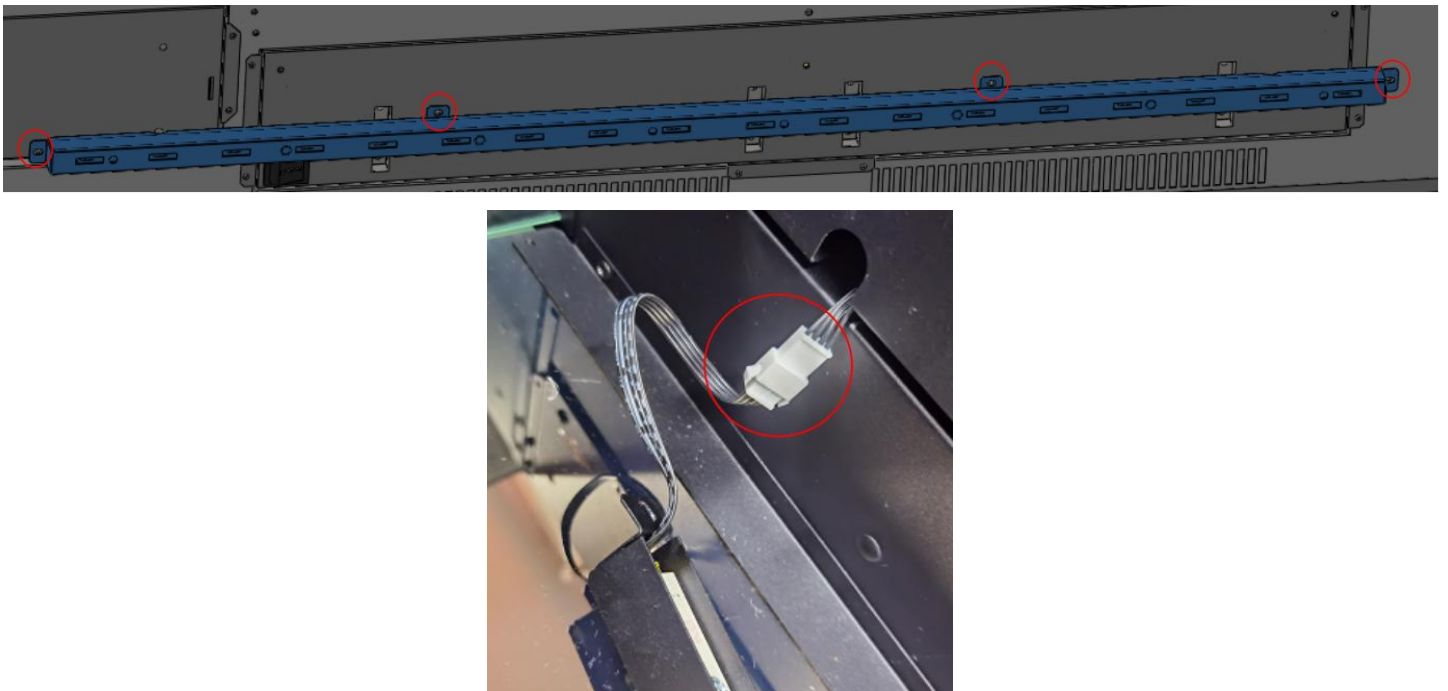

3. Remove 6 ST4\*8 screws as shown in the below picture and take out the heater/blower assembly carefully.

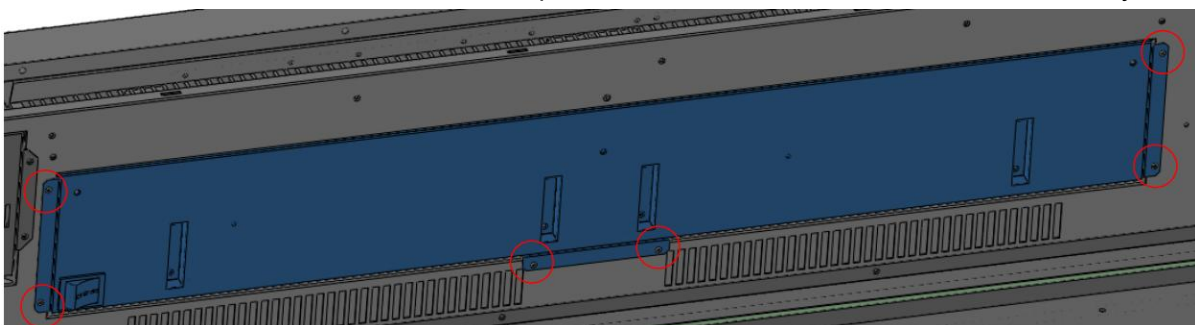

4. Unplug below connection wire, and replace with new heater/blower assembly for Luma Forest CSA. Please make sure the switch is on the corrective positive correspondingly.

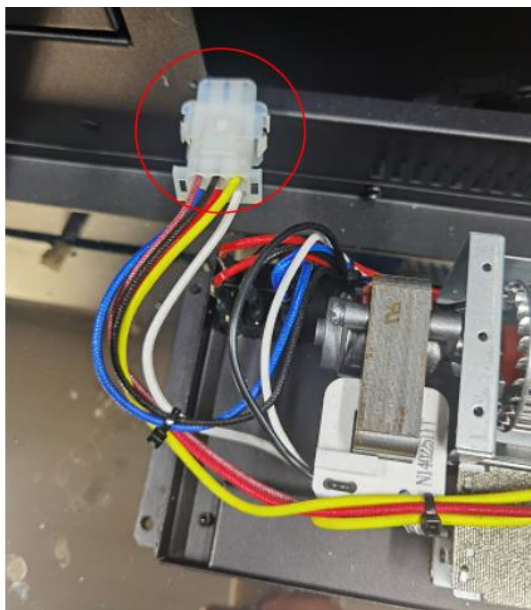

5. Install the fireplace back step by step.